

LEITH LINKS ARBORETUM

CONCEPT LAYOUT PLAN - FOR CONSULTATION

In collaboration with the Royal Botanic Garden Edinburgh, Leith Links is growing tree species from across the globe as part of the effort to conserve them.



Royal
Botanic Garden
Edinburgh



HERE
+ NOW

LEITH LINKS ARBORETUM

An arboretum is a collection of trees grouped by type or common features, such as the continent of origin.

The Royal Botanic Garden Edinburgh has teamed up with the City of Edinburgh Council and the Edinburgh & Lothians Greenspace Trust with funding from the Mushroom Trust to offer an experience which celebrates a diversity of trees from across the world, to enhance Leith Links and offer a local outdoor education resource.

In the proposed design, existing pathways are woven into a cross-cutting flow of paths so that loops can be experienced differently on each encounter, connecting perhaps familiar routes into a mindful wander through interesting and rare tree species.

The routing of the historic golf holes is respected, using the location of the green for hole #3 (East Hole) as a central open space from which the pathways radiate. The tee for hole #4 (South Mid Hole) is incorporated, with a 'fairway' extending to the west allowing for play. A golf course architect was consulted on the space / offsets and locations for these assumptions, however the group who play this historic route should also be consulted.

Environmentally, the site is already fringed by some large trees with considerable canopy spreads, resulting in shady conditions in places. The area for the arboretum is also open to the SW aspect, making some areas exposed to the prevailing wind. Furthermore, the air quality along Claremont Park can be poor due to traffic congestion. These conditions are not an issue, rather the layout will organise appropriate species which are adapted to these conditions.

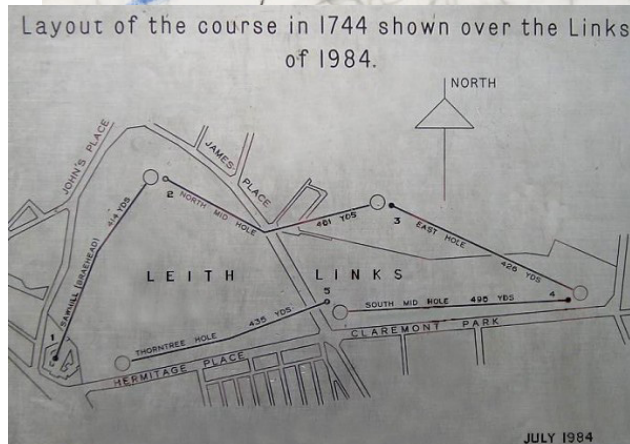

LEITH LINKS ARBORETUM
SITE LOCATION

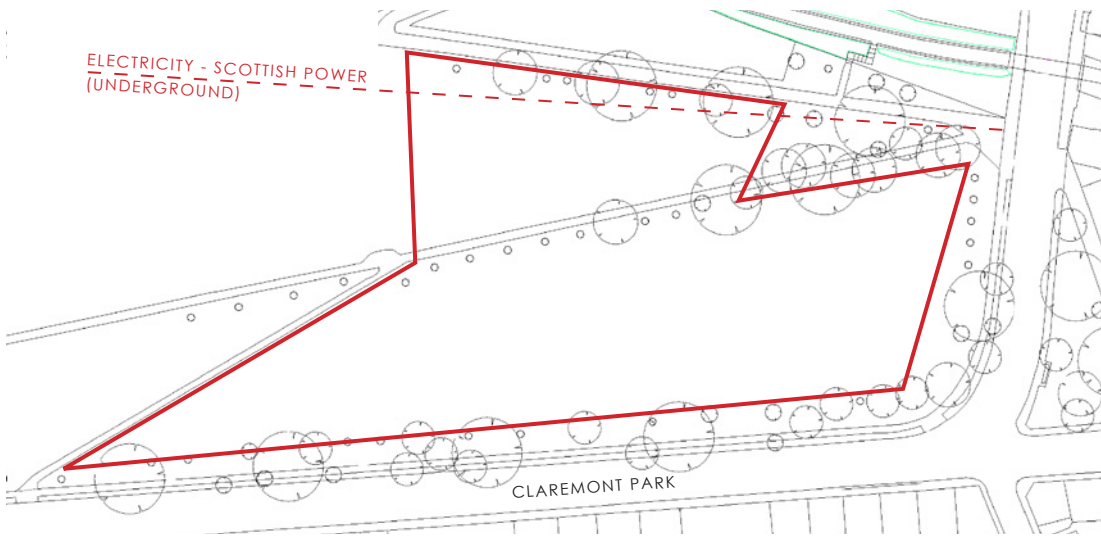
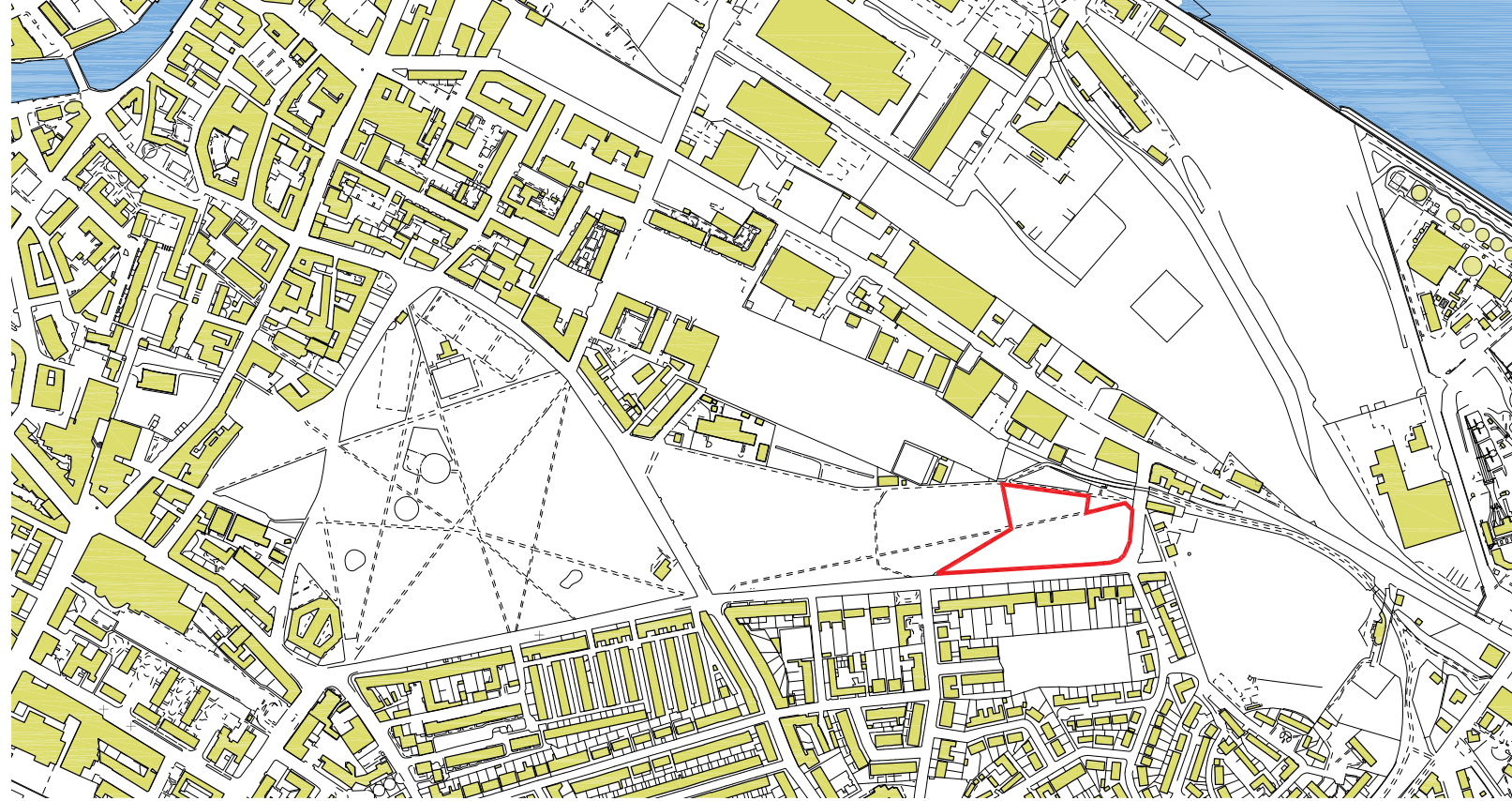

EXTRACTED FROM 'TREE TIME' SURVEY

(ALL PLANS N.T.S.)



LEITH LINKS ARBORETUM TREE SCHEDULE - WITH ID LABELS

The schedule below lists the complete species collection which will be planted as part of the Leith Links arboretum project. They will be planted in phases, as they are sourced and become available.

Many of the conifers in this arboretum are threatened in the wild, so this project is to help safeguard them for future generations. Read more about the Botanics Conifer Conservation Programme: www.rbge.org.uk/science-and-conservation/genetics-and-conservation/conifer-conservation/



	North America	South America	Europe	Asia / Himalayas	Japan / China	Australia	North Africa
Trio of conifers	NA-WG Wellingtonia giganteum - 0.5m / 0.75m - Nursery Wellingtonia giganteum - 0.5m / 0.75m - Nursery Wellingtonia giganteum - 0.5m - Nursery	SA-AA Araucaria araucana - 30cm - Nursery - Future Araucaria araucana - 30cm - Nursery - Future Araucaria araucana - 30cm - Nursery - Future	E-PO Picea omorika - RBGE Picea omorika - RBGE Picea omorika - RBGE	AH-CG Cupressus gigantea - RBGE Cupressus gigantea - RBGE Cupressus gigantea - RBGE	JC-CJ Cryptomeria japonica - 1m / 1.5m - Nursery Cryptomeria japonica - 1m - 1.5m - Nursery Cryptomeria japonica - 1m / 1.5m - Nursery	Au-WN Wollemia nobilis - RBGE Wollemia nobilis - RBGE Wollemia nobilis - RBGE	A-AP Abies pinsapo - RBGE Abies pinsapo - RBGE Abies pinsapo - RBGE
Secondary Group	NA-AR Acer rubrum L. var. trilobum - RBGE NA-QR Quercus rubra - 1m - Nursery NA-LS Liquidambar styraciflua - 0.75m / 1m - Nursery	SA-AA Nothofagus dombeyi 2L - Attempting to Hold - future Nothofagus dombeyi 2L - Attempting to Hold - future Nothofagus dombeyi 2L - Attempting to Hold - future	E-PO Taxus baccata - Barchams - future Quercus robur - Barchams - future	AH-CL Cedrus libani - 0.75m - RBGE Nursery AH-PS Quercus petraea subsp. iberica 2L - Attempting to Hold	JC-GB Ginkgo biloba - RBGE Ginkgo biloba - RBGE Ginkgo biloba - RBGE Ginkgo Biloba - PV hiroshima?	Au-EPD Eucalyptus pauciflora subsp. Debeuzevillei - future Eucalyptus pauciflora subsp. Debeuzevillei - future Eucalyptus pauciflora subsp. Debeuzevillei - future	A-CA Cedrus Atlantica - 2.5m / 3m - 80L HELD Cedrus Atlantica - 2.5m / 3m - 80L HELD Cedrus Atlantica - 2.5m / 3m - 80L HELD
Additional conifers	NA-TH Pseudotsuga menziesii - 150/175cm - 10L HELD Tsuga heterophylla - 0.75m / 1m - Nursery	SA-AC Austrocedrus chilensis - 0.75m - RBGE Nursery SA-FC Fitzroya cupressoides - RBGE	E-PS Pinus Sylvestris scotica - 1.75m / 2m - 40L HELD E-PN Pinus nigra - 1.75m / 2m - 40L HELD	AH-AS Abies spectabilis - RBGE AH-PS Picea schrenkiana - 0.5m - RBGE Nursery	JC-SV Sciadopitys verticillata - RBGE JC-AH Abies homolepis - RBGE	A-CA Cedrus Atlantica "Glauca" - 1.75m / 2m - 40L HELD Cedrus Atlantica "Glauca" - 1.75m / 2m - 40L HELD Cedrus Atlantica "Glauca" - 1.75m / 2m - 40L HELD	
Smaller trees	NA-AM Arbutus menziesii - RBGE Arbutus menziesii - RBGE	E-SP Sorbus pseudofennica - RBGE Sorbus pseudofennica - RBGE Sorbus pseudofennica - RBGE	AH-PP Pyrus pashia - RBGE Pyrus pashia - RBGE Pyrus pashia - RBGE	JC-AR Acer rufinerve - 0.75m - RBGE Nursery Acer rufinerve - 0.75m - RBGE Nursery Acer rufinerve - 0.75m - RBGE Nursery	Au-EPN Eucalyptus pauciflora subsp. niphophila - future Eucalyptus pauciflora subsp. niphophila - future Eucalyptus pauciflora subsp. niphophila - future		
Fillers	NA-LT Liriodendron tulipifera - 1m - Nursery Liriodendron tulipifera - 1m - Nursery	SA-NA Nothofagus antarctica - 1m / 1.5m Nursery Nothofagus antarctica - 1m / 1.5m Nursery Nothofagus antarctica - 1m / 1.5m Nursery	E-CB Carpinus betulus - Barchams - future Carpinus betulus fastigiata - Barchams - future	JC-AP Morus nigra - Barchams - future Morus nigra - Barchams - future Morus nigra - Barchams - future	Au-ER Eucalyptus rodwayi - 1.5m - Nursery Eucalyptus rodwayi - 1.5m - Nursery Eucalyptus rodwayi - 1.5m - Nursery	A-FM Field Maple - Barchams - future Field Maple - Barchams - future Field Maple - Barchams - future	
Hornbeams		E-CB Carpinus caroliniana - SL - Attempting to hold Carpinus caroliniana - SL - Attempting to hold			JC-AP Carpinus fangiana - SL - Attempting to Hold Carpinus turczaninowii - SL - Attempting to Hold		
Oaks	E-QI Quercus coccinea or paulstris - future		E-QI Quercus ilex - 150/175cm - 10L HELD			A-FM Quercus rotundifolia - 2L - Attempting to Hold	
Limes	E-TC Tilia caroliniana ssp. heterophylla 2L - Attempting to Hold		AH-TA Tilia cordata - 0.75m - Nursery	AH-TA Tilia amurensis - RBGE	JC-UP Tilia japonica 2L - Attempting to Hold		
Elms			E-U RBGE rare elm - 0.5m / 0.75m Nursery	JC-UP Ulmus x androsowii - 1SL - Attempting to Hold	JC-UP Ulmus prunifolia - 1m - PN Supply		
Walnuts	NA-JN Juglans nigra - 0.5m - Nursery		E-JR Juglans regia - 1m - Nursery				
Secondary Fillers	E-CS Castanea sativa - 0.5m - Nursery				A-EGJ Zelkova serrata - Barchams - future? A-EGU Eucalyptus glaucescens - 35cm - Nursery Eucalyptus gunni - future Eucalyptus gunni - future Eucalyptus gunni - future		
	NA-MG Magnolia grandiflora - if can be sourced - future Magnolia grandiflora - if can be sourced - future						

(AVAILABLE AS SEPARATE A3 PRINT OUT)

APPLICATION OF THE SCHEDULE OF TREES

Continental / global zones - environmental characteristics could guide the location / arrangement, where broad features could be identified and represented in interpretive materials. The notes below on species is taken from a tree schedule provided by the project partners.

	N. America	S. America	Europe	Asia / Himalayas	Japan / China	Australia	N. Africa
General environmental conditions	Wide range of environmental conditions, elevated land, coastal; tolerate cold, exposure, shade.		Temperate, less extreme temperature ranges than other zones.	More extreme environmental conditions, could be used to shelter European zone on the outside of this planting zone in time creating a microclimate sheltered from the SW winds.	Wide ranging, layout cue from form rather than identifying specific environmental conditions.	Species wind and drought tolerant, might do well within larger areas, note that a lot of the trees are not yet available, so this zone should be set within two others, creating space for future but without losing spatial structure.	Temperature extremes day-night. Periods of drought / water logging
Generalised tree cover form / character	Forests, glades		Individual trees in a wider open landscape, trees achieving wide canopy spreads.	Avenues, linear forms along pathways.	Avenue forms, glades.	Glades of Eucalyptus of different colours and textures.	Stand-alone trees over open plains. Open ground character.
Implications of available species on layout design	Species forming clusters, glades, woodland; planting at closer spacings.		Specimen trees over grassland / wildflower, lush temperate habitats with	Spring flowering Pyrus species; mulberry fruiting / flowering bring close to paths.	Ginko very tolerant of poor air quality. Delicate foliage of Acers would benefit from shelter / screening.	Smell of the Eucalyptus from the main footpath along Claremont Park. Eucalyptus very hardy, will tolerate waterlogged and poor soil conditions.	Multiple Cedrus species total 6no. trees will provide a strong visual and evergreen foil. Set as a backdrop so not overshadowing other areas for tree planting.

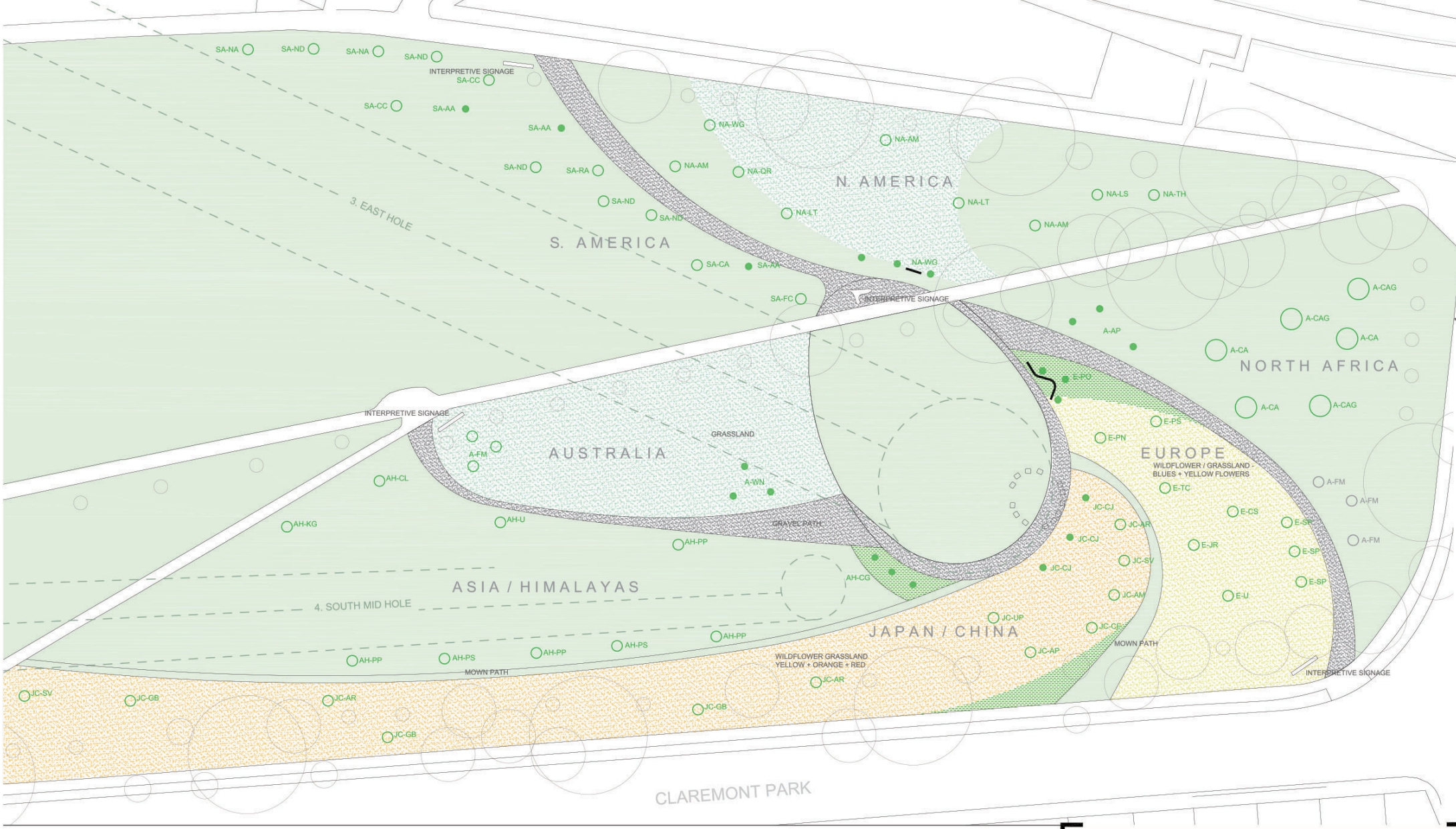

- EXISTING TREES
- PROPOSED ARBORETUM TREES - SEE SCHEDULE
- FUTURE TREES - TO FOLLOW
- EXISTING MOWN GRASS
- WILDFLOWER GRASSLAND - PICTORAL MEADOW MIX 1 / 2 / 3
- GRAVEL PATHS
- POTENTIAL FUTURE PERENNIAL PLANTING - REINFORCING STRUCTURE
- PROPOSED NEW SEATING - METAL BENCHES AROUND TREES
- PROPOSED NEW SEATING - LOGS / 'MUSHROOMS' TO CREATE OUTDOOR CLASSROOM
- PROPOSED INTERPRETIVE SIGNAGE / INSTALLATION

LEITH LINKS ARBORETUM		
SCALE	DATE	DRAWING NUMBER
1:500 @ A3	MAR 2021	L01 v03
DRAWING TITLE		
ARBORETUM CONCEPT DESIGN		

This map is reproduced from Ordnance Survey material with permission of Ordnance Survey on behalf of the Controller of Her Majesty's Stationery Office (c) Crown Copyright. Unauthorised reproduction infringes Crown Copyright and may lead to prosecution or civil proceedings. Licence Number 100023420. City of Edinburgh Council 2007.



-  EXISTING TREES
-  PROPOSED ARBORETUM TREES - SEE SCHEDULE
-  FUTURE TREES - TO FOLLOW
-  EXISTING MOWN GRASS
-  WILDFLOWER GRASSLAND - PICTORAL MEADOW MIX 1 / 2 / 3
-  GRAVEL PATHS
-  POTENTIAL FUTURE PERENNIAL PLANTING - REINFORCING STRUCTURE
-  PROPOSED NEW SEATING - METAL BENCHES AROUND TREES
-  PROPOSED NEW SEATING - LOGS / 'MUSHROOMS' TO CREATE OUTDOOR CLASSROOM
-  PROPOSED INTERPRETIVE SIGNAGE / INSTALLATION

LEITH LINKS ARBORETUM

SCALE	DATE	DRAWING NUMBER
1:500 @ A3	MAR 2021	L01 v03
DRAWING TITLE		
ARBORETUM CONCEPT DESIGN		

This map is reproduced from Ordnance Survey material with permission of Ordnance Survey on behalf of the Controller of Her Majesty's Stationery Office (c) Crown Copyright. Unauthorised reproduction infringes Crown Copyright and may lead to prosecution or civil proceedings. Licence Number 100023420. City of Edinburgh Council 2007.