

Field Guide to USDA-ARS TARS Plant Collections

USDA



United States Department of Agriculture

Agricultural Research Service

How to use this guide

This field guide is to be used to locate and/or identify unique plant germplasm accessions within the diverse germplasm collections on the USDA-ARS Tropical Agriculture Research Station grounds. It can be used in several ways, but the following steps provide a general guide.

1. Identify plant by common name and/or by scientific name (binomial) in the guide's index.
2. Find scientific name of plant in specified table.
3. Identify TARS number and Location quadrant from table.
4. Find corresponding field plot and identify accession location based on TARS number and map quadrant.

Acknowledgements: This field guide is the compilation of work performed by many important contributors over the years. Contributors include volunteers and students as well as technical and scientific staff that have worked on the plant germplasm collection on the grounds of the USDA-ARS Tropical Agriculture Research Station since its inception in 1902. We recognize the recent efforts in improving the field guide and diverse germplasm collections by Jose 'Cheo' Cancel, Luis De La Cruz, Alcides Morales, Miguel Roman and Pedro Torres. Also, authors acknowledge Drs. John Wiersema and Duane Kolterman for their critical review of the document.

Disclaimer: All efforts were made to properly identify the plant germplasm on the station grounds and in this 'Field Guide'. If mistakes are identified, we would appreciate editorial comments and or suggestions. These can be sent via email to Brian Irish (Brian.Irish@ars.usda.gov). Lastly, this printed/PDF Field Guide ver. 1.0 is a static document whereas plant taxonomy is dynamic. Therefore, updated scientific names (binomials) and accompanying taxonomy will be addressed in future versions.

Citation

Irish, B.M., Rios, C.J., and Goenaga, R. 2014. Field Guide to the USDA-ARS, TARS Plant Germplasm Collections.

Table of Contents

TARS History, Mission and Organization	i
Research Facilities	iv
Satellite map of location grounds	v
Plots 1-2	1
Plots 3-4	4
Plots 5-12	6
Plots 13-15	10
Plot 16	15
Plot 17	17
Plot 18	20
Plot 19	23
Plot 20	25
Plots 21-23	28
Plot 24	30
Plot 25	32
Plot 26	35
Index	38

TARS History, Mission and Organization

The Tropical Agriculture Research Station (TARS) at Mayaguez, Puerto Rico, is part of the South Atlantic Area, Agricultural Research Service, United States Department of Agriculture. In 1901, the Congress of the United States appropriated \$5,000 and directed the Secretary of Agriculture to take the necessary steps to establish an experiment station in Puerto Rico to study agricultural problems of interest to the island. The Governor of Puerto Rico, in cooperation with the communities of the island and representatives of the United States Department of Agriculture selected the present site of the station at Mayaguez, on the farm known as Hacienda Carmen. The Government of Puerto Rico donated the land, and the station began operations in 1902. The early years (1901-1930) of the station were devoted primarily to introduction of new crops and new varieties of crops in order to meet the agricultural needs of the island. Since 1935, TARS has gradually modified its research program to the point where most of its research is now concerned with the fundamental aspects of problems related to national/regional agriculture. TARS proximity to the University of Puerto Rico, Mayaguez Campus, has encouraged cooperative research programs with the College of Agricultural Sciences and its Agricultural Experiment Stations for many decades.

The mission of the Tropical Agriculture Research Station (TARS) is to conduct agricultural research to: 1) assess tropical sorghum and dry bean genetic resources for disease resistance and genetic diversity and develop germplasm adapted to temperate regions, and 2) to introduce, preserve, evaluate, regenerate, distribute and develop cultural and management systems for tropical/subtropical crops that are of economic importance to the Continental and Insular United States. All research projects form part of National Program 301: Plant Genetic Resources, Genomics and Genetic Improvement and National Program 305: Crop Production.

To fulfill the station's mission, the research program is divided into the following projects:

Evaluation and genetic analyses of sorghum genetic resources for key agronomic traits. Sorghum is the fifth most important grain crop and an important source of grain-based ethanol. However, sorghum productivity and quality is threatened by fungal diseases, with anthracnose and grain mold among the most damaging. The identified resistance genes present in exotic germplasm are potentially the most effective strategy to control these diseases. Nevertheless, the development of resistant germplasm has been impeded by limited knowledge of the inheritance and genetic control of these diseases. Therefore, the focus of this research is to determine the genetic control of anthracnose and grain mold, to identify molecular markers for disease breeding programs, and to discover new sources of resistance present in exotic germplasm. Genome-wide association studies will be employed to understand the genetic control and locate the genome regions of the anthracnose and grain mold resistance genes. The genetic and morphological characterization of sorghum collection from Ethiopia and Sudan will be applied to develop core subsets for further association studies, and to identify new sources of host resistance. Presently, sweet sorghum varieties utilized as a biofuel source have a narrow genetic base. Therefore, the evaluation of sweet sorghum accessions present in the United States sorghum collection will help to identify new germplasm to broaden genetic variability available for the development of new biofuel varieties of sorghum.

Genetic Enhancement of Common Bean Using Exotic Germplasm for Biotic and Abiotic Stress Tolerance. Common bean (*Phaseolus vulgaris*) is the most important food legume worldwide, grown in 148 countries on 27.7 million hectares, with the United States earning about \$1.8 billion annually from exports. Bean consumption in the United States is increasing as a result of its health benefits, yet climate change threatens future production. An important limitation to common bean genetic improvement in the United States is the narrow genetic diversity available to scientists in breeding programs. Introgression of new sources of abiotic stress tolerance, especially for heat and drought stress, as well as disease and insect resistance, into common bean is required to achieve significant yield improvement.

Use of innovative sources of valuable traits, such as tropical exotic germplasm and highly stress tolerant sister species, is required to identify, locate, and characterize the novel genes controlling these traits and to speed the development of improved germplasm and cultivars. The breeding and deployment of drought, heat, disease and pest resistant germplasm and varieties, is critical to ensure continued United States bean production. Although sources of tolerance and resistance have been identified for some traits, additional genetics, markers, and breeding are needed. In order to develop these resources, the following three objectives are proposed: identify, map and develop markers for heat, drought, and root rot resistance in common bean; develop and release common bean germplasm with higher levels of tolerance to heat, drought, root rot pathogens and leafhoppers; and introgress abiotic stress tolerance from tepary bean (*Phaseolus acutifolius*) into common bean, and develop tepary as a new crop.

Germplasm Regeneration, Characterization, Evaluation and Phytosanitary Assessment of Quarantined and Tropically-Adapted Genetic Resources. Plant germplasm currently available in the United States may not be sufficiently diverse, stored in sufficient amounts, or phenotypically evaluated to meet the objectives of crop improvement programs. Consequently, breeders depend on foreign germplasm to solve crop production problems. Because of USDA quarantine regulations, the seed of important grain crops introduced from abroad must be grown under quarantine and certified as free from potentially harmful exotic pathogens before seed is released domestically. Similarly, to ensure an adequate amount of seed, particularly photoperiod-sensitive germplasm, seed with low viability or in low supply must be regenerated and made available to breeders. To provide breeders with genetically diverse materials in adequate supply and characterized, the following objectives will be accomplished: 1) Regenerate seed supplies for priority accessions of crop genera *Vigna*, *Cucurbita*, *Ipomoea*, *Pennisetum*, *Zea*, *Sorghum* and tropical legume genera which are adapted to equatorial latitudes, and assessed for phytosanitary factors under quarantine conditions; 2) Characterize and evaluate (phenotype) germplasm accessions of priority genera, cultivated for regeneration and/or released from quarantine, for crop-specific descriptors and for priority agronomic traits and, ensure that those data are incorporated into GRIN-Global or other databases. To achieve these objectives quarantined germplasm of maize and sorghum will be field grown under close monitoring of pests and diseases of quarantine significance. Also, tropically-adapted accessions of these crops and cowpea, pearl millet, cucurbits, sweet potato, and tropical legumes having low seed viability or in low supply will be field grown and increased. Achievements of these objectives will result in increased genetic diversity and adequate seed availability and associated information to breeders in crop improvement programs.

Management strategies to improve subtropical/tropical fruit crop production. The increase in ethnic diversity in the United States, along with changes in the dietary habits of the public for health considerations, have opened a large market for subtropical/tropical fruits. Development of efficient and sustainable management systems and identification of superior cultivars yielding high quality fruits are of paramount importance to ensure the success and sustained production of the emerging subtropical/tropical fruit industry in the United States. However, increased production of many tropical fruit crops is hindered by a lack of basic information on how physiological, horticultural, entomological, and pathological variables, as well as management practices, affect fruit production systems and how these interact to influence yield and fruit quality. In order to provide this critical information, the following objectives will be accomplished: 1) Devise optimum production practices for tropical fruit crops that help expand local and export markets; 2) Evaluate the performance of selected cultivars of tropical fruit crops for tolerance to economically-limiting diseases; 3) Evaluate and develop new means for reducing or eliminating the threat and impact of key insect pests and the ability of insect vectors to transmit specific diseases; 4) Develop means of increasing the effectiveness of pollinators that maximize crop productivity. To achieve these objectives, promising varieties of selected tropical fruit crops must be evaluated by a multi-disciplinary research team at various agroenvironments for tolerance to pests and diseases, yield, fruit quality, acid soil tolerance, pollinator efficiency, and nutrient use efficiency. Achievement of these objectives will assist in the expansion of the subtropical/tropical fruit industry in the United States.

Management of Tropical/Subtropical Genetic Resources and Associated Information. The USDA-ARS Tropical Agriculture Research Station is the only research entity within the National Plant Germplasm system in the insular Caribbean region. It houses germplasm collections of cultivated tropical/subtropical germplasm of bananas/plantains, cacao, mamey sapote, sapodilla, Spanish lime, species in the *Annona* and *Garcinia* genera, and bamboo. The lack of well established, organized and properly maintained ex situ germplasm collections could mean the loss of useful genetic resources. Cacao, tropical fruit germplasm and bamboo collections exist, however genetic diversity is underrepresented and accessions lack characterization data. Cacao, tropical fruit and bamboo genetic resources will be added to existing collections, maintained, characterized and distributed which will aid in diversifying Puerto Rico's and the region's agricultural economies. Germplasm genotypic characterizations will utilize current and novel molecular approaches for determination of genetic integrity and for estimation of genetic diversity. Deficiencies identified in genetic diversity comprehensiveness will be addressed by introduction of representative germplasm. In vitro and cryopreservation techniques will be assessed for their increased propagation efficiency, ease of distribution and for backup purposes. In addition, cacao, mango, papaya and *Musa* spp. genetic resources will be evaluated for priority horticultural traits. All data (genotypic/phenotypic) will be made available to stakeholders via scientific presentations, publications, websites and the GRIN-Global database and disease-tested genetic resources will be distributable, in limited quantities, for research and educational purposes. Progress in cacao and tropical fruit germplasm, genetics, genomics, genetic improvement, and production will be accelerated by the information and genetic resources furnished by this project.

Soybean Germplasm Development. This program includes generation advancement (winter nurseries) and seed increase of soybean. It provides scientists in many United States research institutions a unique opportunity to accelerate the development of new lines, hybrids and varieties of this crop.

Research Facilities

The in-house facilities in Mayaguez consists of 200 acres of land; laboratories and offices for research and support for seven scientists; 13 screenhouses; a plant propagation unit; a cold storage unit; and provides additional office space for the local USDA Natural Resources Conservation Service and USDA-APHIS-Plant Protection and Quarantine. In addition, a 130-acre farm located in Isabela is utilized to support our research programs. A 58-acre research farm located at St. Croix, United States Virgin Islands serves as a quarantine and seed regeneration site for several crops. A research support agreement with the University of Puerto Rico permits conducting work at the various research farms belonging to the UPR-Agricultural Experiment Station.

The USDA-ARS-TARS forms part of the National Plant Germplasm System (NPGS) which is a network of organizations and people dedicated to preserving the genetic diversity of crop plants. As a germplasm repository of tropical crops TARS is responsible for acquiring, preserving, evaluating, and distributing germplasm of cacao, banana, plantain, mamey sapote, sapodilla, *Annona* spp., *Garcinia* spp., and both tropical and temperate bamboo. Over 250 genera and 400 species of other plants also grow on TARS grounds and these are distributed worldwide as well. A mango backup germplasm collection is also maintained at TARS. Documentation for many of the crop and ornamental species at TARS can be found in the Germplasm Resources Information Network (GRIN) database at <http://www.ars-grin.gov>.

This field guide provides an inventory and location of crop and ornamental species under the responsibility of TARS.

Tropical Agriculture Research Station - E1 (Detail)

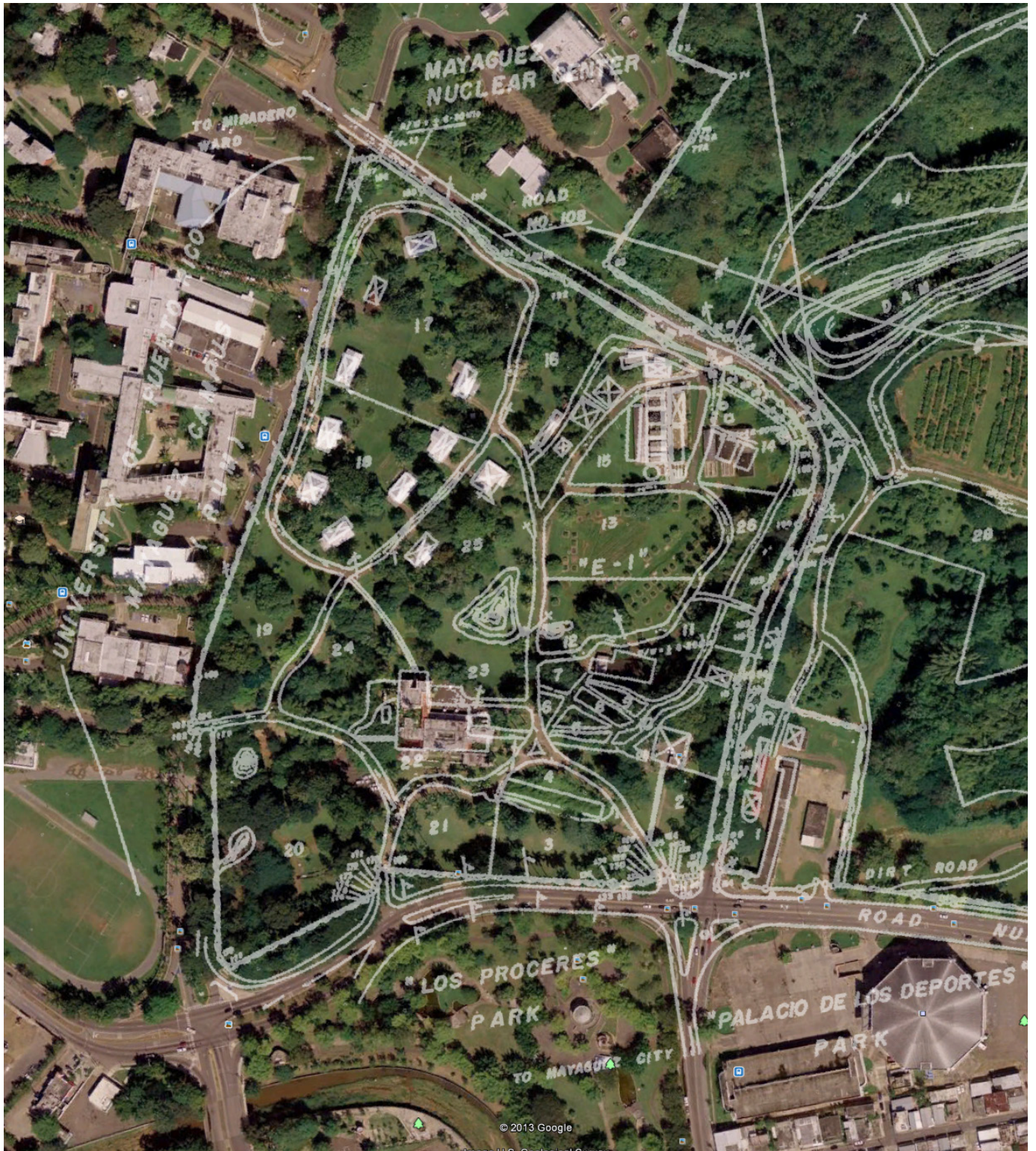

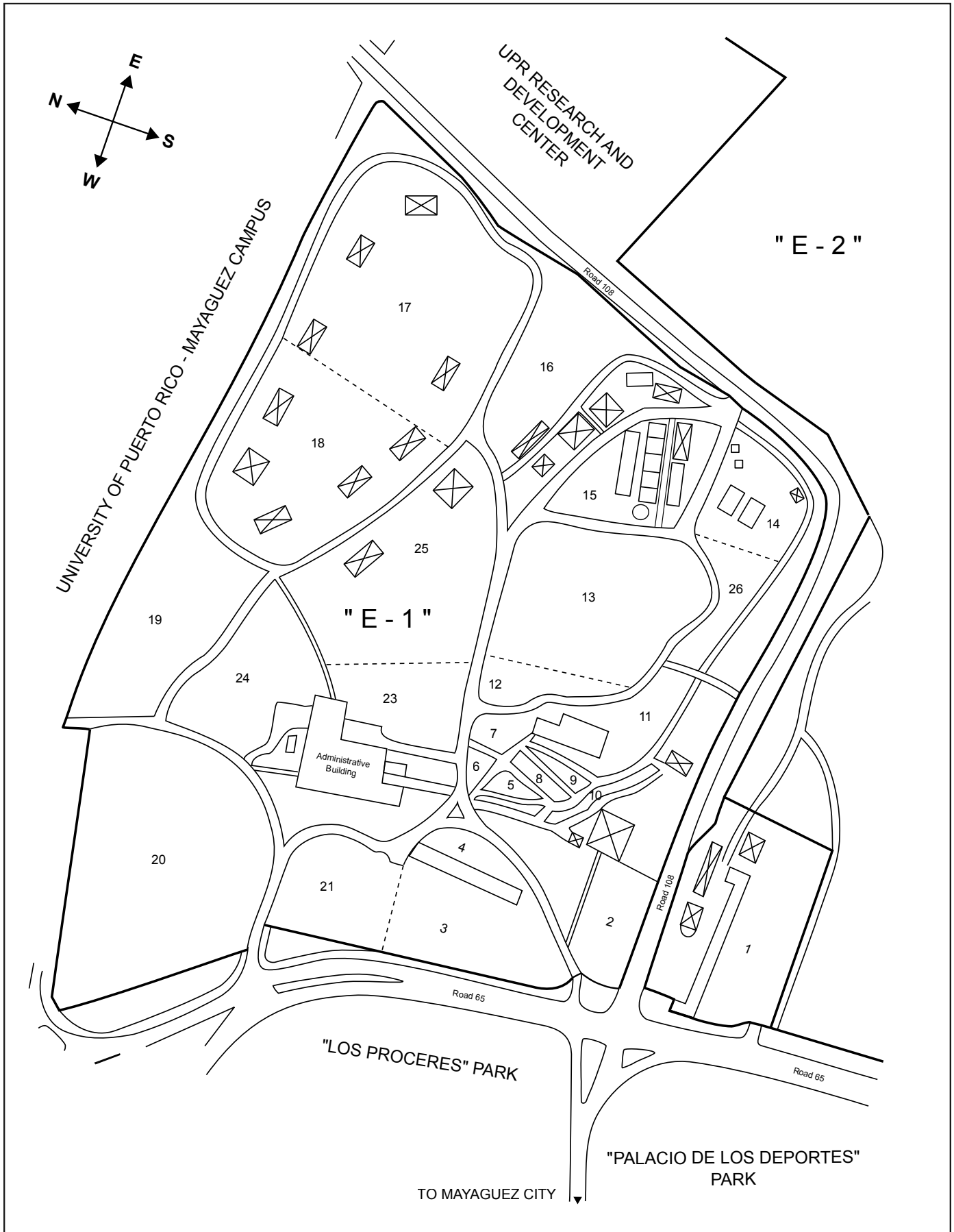

General Inventory - E1 (Plots 1-2)

TARS No.	Binomial	Family	Common Name	Location
4	<i>Couroupita guianensis</i>	Lecythidaceae	Cannonball Tree	A3, B2
9	<i>Persea americana</i>	Lauraceae	Avocado	B3
62	<i>Ravenala madagascariensis</i>	Strelitziaceae	Traveler's Palm	A3
69	<i>Delonix regia</i>	Fabaceae	Royal Poinciana	B4
173	<i>Melicoccus bijugatus</i>	Sapindaceae	Quenepa	C1
348	<i>Parmentiera aculeata</i>	Bignoniaceae	Guajilote	B1
1006	<i>Enterolobium cyclocarpum</i>	Fabaceae	Elephant's ear	B3
1076	<i>Swietenia macrophylla</i>	Meliaceae	Honduras Mahogany	A3, B2
1111	<i>Codiaeum variegatum</i>	Euphorbiaceae	Croton	B2
1123	<i>Sapindus saponaria</i>	Sapindaceae	Soapberry	B1
1207	<i>Aleurites moluccanus</i>	Euphorbiaceae	Candleberry	B2
1207A	<i>Adenanthera pavonina</i>	Fabaceae	Red Sandalwood Tree	B2
1345	<i>Lagerstroemia speciosa</i>	Lythraceae	Queen Crape Myrtle	A3
1435	<i>Terminalia muelleri</i>	Combretaceae	Mueller's Terminalia	B2
1520	<i>Flacourtia</i> sp.	Salicaceae	-	B1
1559	<i>Samanea saman</i>	Fabaceae	Saman	C2
1566	<i>Artocarpus heterophyllus</i>	Moraceae	Jackfruit	A3
1636	<i>Roseodendron donnell-smithii</i>	Bignoniaceae	White Mahogany	B4
1737	<i>Cavanillesia platanifolia</i>	Malvaceae	Panama Canoe Tree	B2
1745	<i>Parkia biglandulosa</i>	Fabaceae	Parkia	A3
1922	<i>Combretum indicum</i>	Combretaceae	Ragoon Creeper	B4
1924	<i>Holmskioldia sanguinea</i>	Lamiaceae	Chinese Hat Flower	B4
1925	<i>Jasminum multiflorum</i>	Oleaceae	Furry Jasmine	A3
1995	<i>Synsepalum dulcificum</i>	Sapotaceae	Miracle Fruit	B2
2371	<i>Hibiscus rosa-sinensis</i>	Malvaceae	Common Hibiscus	B2
2609	<i>Handroanthus chrysanthus</i>	Bignoniaceae	Roble Amarillo, Yellow Poui	B4
2667	<i>Kleinhovia hospita</i>	Malvaceae	Guest Tree	C1
2680	<i>Polygala cowellii</i>	Polygalaceae	Puerto Rican Violet Tree	B3, B4
4673	<i>Pimenta racemosa</i>	Myrtaceae	Bay Rum Tree, Malagueta	B2
6001	<i>Dypsis lutescens</i>	Arecaceae	Golden Palm	B3, C4
6870	<i>Roystonea borinquena</i>	Arecaceae	Puerto Rican Royal Palm	A3
6936	<i>Ixora coccinea</i>	Rubiaceae	Maltese Cross	B3
7120	<i>Araucaria heterophylla</i>	Araucariaceae	Norfolk Island Pine	B3
7122	<i>Ixora acuminata</i>	Rubiaceae	Sharpleaf Ixora	B2
8167	<i>Adonidia merrillii</i>	Arecaceae	Manila Palm	B3
8683	<i>Kigelia africana</i>	Bignoniaceae	Sausage Tree	B2, B3
8944	<i>Uvaria rufa</i>	Annonaceae	Calabao	B2
10143	<i>Diospyros dygina</i>	Ebenaceae	Black Sapote	C1
10705	<i>Ficus elastica</i> 'Decora'	Moraceae	India Rubber Fig	B1
10742	<i>Delonix regia</i>	Fabaceae	Flamboyant Tree	C3
13211	<i>Severina buxifolia</i>	Rutaceae	Chinese Box Orange	B2
16301	<i>Cocos nucifera</i>	Arecaceae	Coconut Palm	B3
16037	<i>Citrus maxima</i> 'Ogami'	Rutaceae	Pomelo	B4

General Inventory - E1 (Plots 1-2)

TARS No.	Binomial	Family	Common Name	Location
16095	<i>Citrus maxima</i> 'Kao Pane'	Rutaceae	Pomelo	B4
17948	<i>Thespesia grandiflora</i>	Malvaceae	Maga	B3
17981	<i>Thuja</i> sp.	Cupressaceae	Arborvitae	A3
18086	<i>Jacaranda mimosifolia</i>	Bignoniaceae	Blue Jacaranda	B3
18090	<i>Euterpe oleracea</i>	Arecaceae	Açaí Palm	A3
18168	<i>Holmskioldia sanguinea</i>	Lamiaceae	Chinese Hat (Red)	B4
18276	<i>Pachystachys coccinea</i>	Acanthaceae	Cardinal's Guard	A3

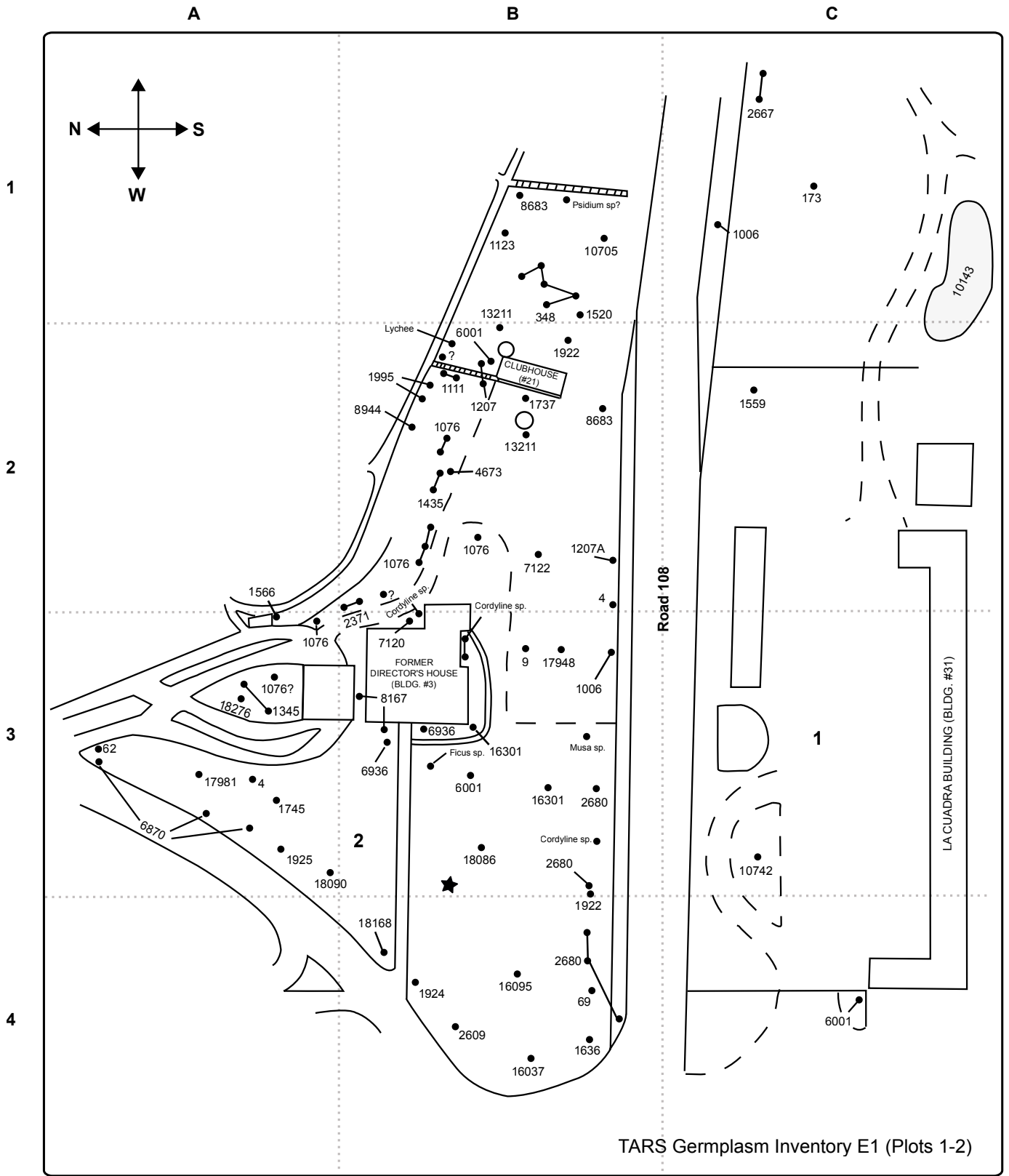

TARS Germplasm Inventory E1 (Plots 1-2)

★ GPS Coordinates: N 18°12.434 W 67°08.229

General Inventory - E1 (Plots 3-4)

TARS No.	Binomial	Family	Common Name	Location
25	<i>Brownea grandiceps</i>	Fabaceae	Rose of Venezuela	A2
224	<i>Arenga tremula</i>	Arecaceae	Philippine Sugar Palm	C2
261	<i>Polyalthia suberosa</i>	Annonaceae	-	B2
1006	<i>Enterolobium cyclocarpum</i>	Fabaceae	Elephant Ear	A3
1477	<i>Congea tomentosa</i>	Verbenaceae	Shower of Orchids	Several
1564	<i>Psidium microphyllum</i>	Myrtaceae	Puerto Rican Guava	D2
1625	<i>Garcinia binucao</i>	Clusiaceae	-	D2
1744	<i>Pandanus dubius</i>	Pandanaceae	Bakong	B1
1802	<i>Corypha umbraculifera</i>	Arecaceae	Talipot Palm	A2
1819	<i>Caryota urens</i>	Arecaceae	Giant Fishtail Palm	B2
1881	<i>Garcia nutans</i>	Euphorbiaceae	False Tung Oil Tree	A2
1919	<i>Litchi chinensis</i> subsp. <i>philippinensis</i>	Sapindaceae	Alupag	A2
1926	<i>Carludovica palmata</i>	Cyclanthaceae	Panama Hat Palm	B2, C2
4895	<i>Callistemon citrinus</i>	Myrtaceae	Bottlebrush Tree	C2
4904	<i>Myrospermum frutescens</i>	Fabaceae	Cereipo	C3
6023	<i>Epipremnum pinnatum</i>	Araceae	Ivy-Arum	A2
6398	<i>Ptychosperma macarthurii</i>	Arecaceae	Macarthur's Palm	A3
6870	<i>Roystonea borinquena</i>	Arecaceae	Puerto Rican Royal Palm	Several
7120	<i>Araucaria heterophylla</i>	Araucariaceae	Norfolk Island Pine	B2
7139	<i>Caryota</i> sp.	Araceae	Fishtail Palm	B2
8420	<i>Syngonium podophyllum</i>	Araceae	Nephthytis	C2
11868	<i>Bauhinia monandra</i>	Fabaceae	Butterfly Flower	B3
15891	<i>Syagrus romanzoffiana</i>	Arecaceae	Queen Palm	B3
16294	<i>Borassus flabellifer</i>	Arecaceae	Palmyra Palm	B2
17930	<i>Bismarckia nobilis</i>	Arecaceae	Bismarck Palm	C2
17944	<i>Cecropia peltata</i>	Cecropiaceae	Trumpet Tree, Yagrumo	B2, C2
17949	<i>Syagrus oleracea</i>	Arecaceae	Catole Palm	A3
17950	<i>Syagrus coronata</i>	Arecaceae	Licury Palm	C2
17952	<i>Dyopsis madagascariensis</i>	Arecaceae	Lucuba Palm	C3
18032	<i>Calamus viminalis</i>	Arecaceae	Rattan	C2
18070	<i>Prestoea acuminata</i>	Arecaceae	Mountain Cabbage Palm	C2
18170	<i>Phoenix sylvestris</i>	Arecaceae	Silver Date Palm	B3
18262	<i>Hyophorbe verschaffeltii</i>	Arecaceae	Spindle Palm	B3, C3

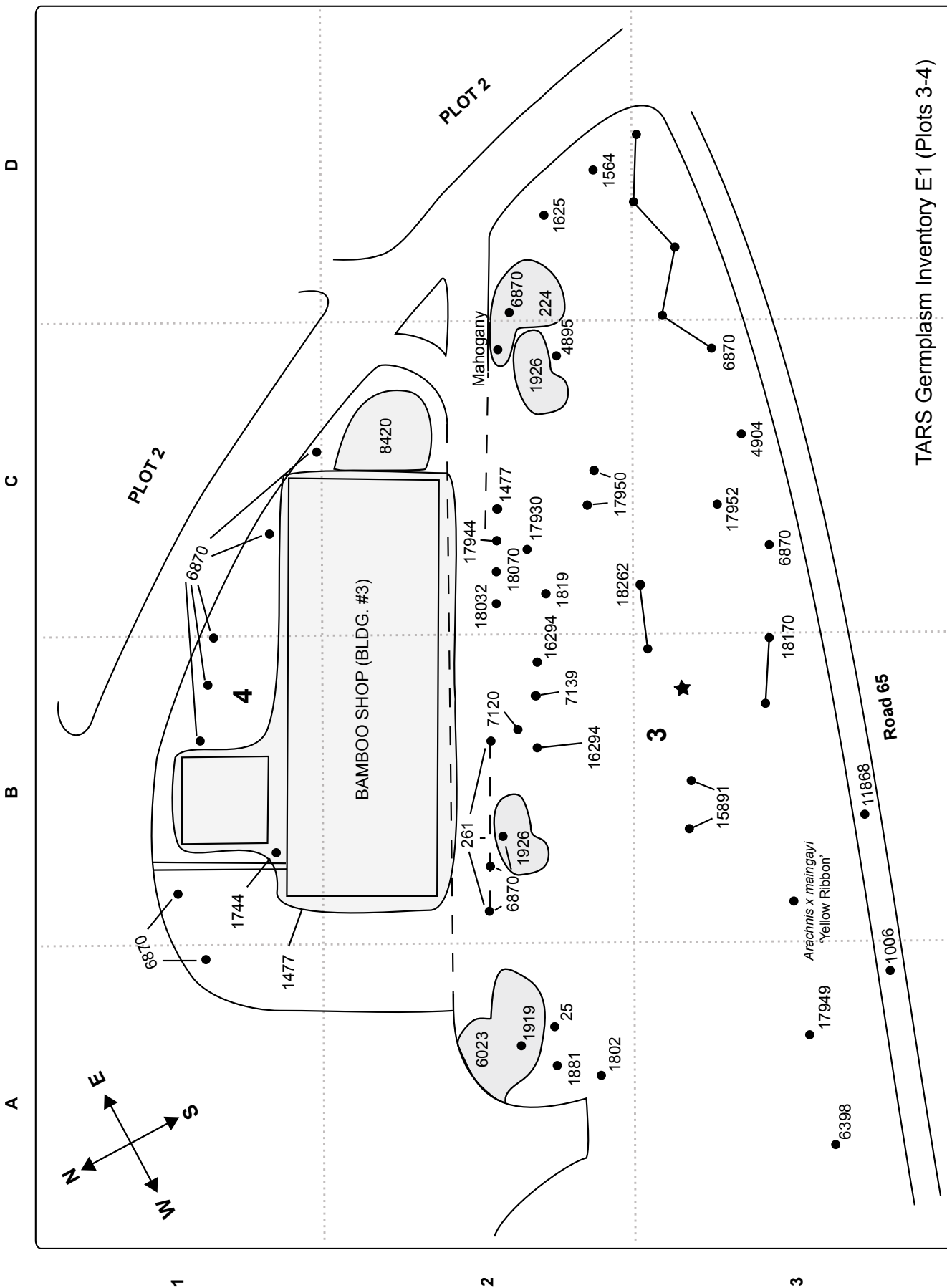

TARS Germplasm Inventory E1 (Plots 3-4)

★ GPS Coordinates: N 18°12.436 W 67°08.269

General Inventory - E1 (Plots 5-12)

TARS No.	Binomial	Family	Common Name	Location
1	<i>Dillenia indica</i>	Dilleniaceae	Dilenia	C2
11	<i>Monstera deliciosa</i>	Araceae	Mexican Breadfruit, Ceriman	B2, C2
68	<i>Costus spicatus</i>	Costaceae	Spiked Spiral Flag	C2
112	<i>Pithecellobium dulce</i>	Fabaceae	Manila Tamarind	C1
177	<i>Swietenia macrophylla</i>	Meliaceae	Honduras Mahogany	B2
288	<i>Swietenia macrophylla</i>	Meliaceae	Honduras Mahogany	B1
504	<i>Parmentiera cereifera</i>	Bignoniaceae	Candle Tree	C2
1111	<i>Codiaeum variegatum</i>	Euphorbiaceae	Croton	C1, D1
1121	<i>Myristica fragrans</i>	Myristicaceae	Nutmeg and Mace	C1
1123	<i>Sapindus saponaria</i>	Sapindaceae	Soapberry	A3
1207B	<i>Arenga pinnata</i>	Arecaceae	Sugar Palm	C1
1303	<i>Lansium domesticum</i>	Meliaceae	Langsat	A3
1471	<i>Posoqueria latifolia</i>	Rubiaceae	Needle-flower Tree	B2
1555	<i>Etlingera elatior</i>	Zingiberaceae	Pink Torch Ginger	B2, C1
1566	<i>Artocarpus heterophyllus</i>	Moraceae	Jackfruit	C1, C2
1629	<i>Hyophorbe verschaffeltii</i>	Arecaceae	Spindle Palm	C1
1640	<i>Senna multijuga</i>	Fabaceae	False Sicklepod	B2, B3
1718	<i>Alpinia zerumbet</i>	Zingiberaceae	Pink Porcelain Lily	C1
1732	<i>Petrea volubilis</i>	Verbenaceae	Purple Wreath	D2
1787	<i>Pyrostegia venusta</i>	Bignoniaceae	Flame Vine	D1
1802	<i>Corypha umbraculifera</i>	Arecaceae	Talipot Palm	D1, B2
1919	<i>Litchi chinensis</i> subsp. <i>philippinensis</i>	Sapindaceae	Alupag	SH
1926	<i>Carludovica palmata</i>	Cyclanthaceae	Panama Hat Palm	A3
2680	<i>Polygala cowellii</i>	Polygalaceae	Puerto Rican Violet Tree	D1
3305	<i>Mammea americana</i>	Clusiaceae	Mamee Apple, Mamey	B3
4673	<i>Pimenta racemosa</i>	Myrtaceae	Bay Rum Tree, Malagueta	D1
4734	<i>Arenga pinnata</i>	Arecaceae	Sugar Palm	C1
4821	<i>Cinnamomum verum</i>	Lauraceae	Cinnamon Tree	D2
4956	<i>Cinnamomum aromaticum</i>	Lauraceae	Chinese Cinnamon	D1
4909	<i>Ophiopogon japonicus</i>	Convallariaceae	Mondo Grass, Dwarf Lilyturf	D1-2, C2
4997	<i>Pachira aquatica</i>	Malvaceae	Guiana Chestnut	A3
5697	<i>Vanda</i> hybrid	Orchidaceae	Miss Agnes Joaquin	C2, B3
5833	<i>Alpinia purpurata</i>	Zingiberaceae	Red Ginger	D3
6392	<i>Heliconia latispatha</i>	Heliconiaceae	-	C3
6622	<i>Dioon edule</i>	Zamiaceae	-	C2
6623	<i>Dioon spinulosum</i>	Zamiaceae	-	B1
6743	<i>Cordyline fruticosa</i>	Lomandraceae	'Concha Capifali'	D2
6861	<i>Cyperus involucratus</i>	Cyperaceae	Umbrella Sedge	D1
6862	<i>Dracaena fragrans</i>	Asparagaceae	-	C3
6870	<i>Roystonea borinquena</i>	Arecaceae	Puerto Rican Royal Palm	Several
7716	<i>Triphasia trifolia</i>	Rutaceae	Jerusalem Lemon	C1
8420	<i>Syngonium podophyllum</i>	Araceae	Nephthytis	D1
9388	<i>Cheilocostus speciosus</i>	Costaceae	Crepe Ginger	D2

General Inventory - E1 (Plots 5-12)

TARS No.	Binomial	Family	Common Name	Location
9339	<i>Attalea gomphococca</i>	Arecaceae	-	D2
10079	<i>Zingiber zerumbet</i>	Zingiberaceae	Martinique Ginger	C2
12404	<i>Piper nigrum</i>	Piperaceae	Black Pepper	SH
15219	<i>Garcinia cymosa</i>	Clusiaceae	-	SH
15373	<i>Monodora myristica</i>	Annonaceae	African Nutmeg	B2
15446	<i>Amorphophallus paeoniifolius</i>	Araceae	Elephant Yam	SH
16293	<i>Bischofia javanica</i>	Euphorbiaceae	Japanese Bishopwood	C2
16302	<i>Coffea arabica</i>	Rubiaceae	Coffee	A3
16314	<i>Hibiscus schizopetalus</i>	Malvaceae	Coral Hibiscus	B2
16319	<i>Nephelium lappaceum</i>	Sapindaceae	Rambutan	C2
16321	<i>Odontonema tubaeforme</i>	Acanthaceae	-	D1
16339	<i>Sterculia foetida</i>	Malvaceae	Java Olive	B1
16358	<i>Averrhoa carambola</i>	Oxalidaceae	Golden Star	D2
16734	<i>Theobroma cacao</i>	Malvaceae	Cacao 'Colorado'	B2
17168	<i>Musa acuminata</i>	Musaceae	Grand Nain	C2
17213	<i>Artocarpus odoratissimus</i>	Moraceae	Marang	A3
17329	<i>Alpinia purpurata</i>	Zingiberaceae	Tahitian	D3
17332	<i>Heliconia</i> sp.	Heliconiaceae	Tortuga Hybrid	D2
17334	<i>Heliconia mariae</i>	Heliconiaceae	Beefsteak Heliconia	D3
17335	<i>Alpinia zerumbet</i>	Zingiberaceae	Variiegated Shell	D3
17337	<i>Alpinia purpurata</i>	Zingiberaceae	Rosy Dawn	C2
17404	<i>Musa acuminata</i>	Musaceae	Kirkinan	C2
17847	<i>Averrhoa carambola</i>	Oxalidaceae	Hew #1	A3
17848	<i>Averrhoa carambola</i>	Oxalidaceae	Thai Knight	A3, B3
17849	<i>Averrhoa carambola</i>	Oxalidaceae	B-10	B2
17850	<i>Averrhoa carambola</i>	Oxalidaceae	Hart	A3
17851	<i>Averrhoa carambola</i>	Oxalidaceae	Key West	A2, B2
17852	<i>Averrhoa carambola</i>	Oxalidaceae	Wheeler	B2
17853	<i>Averrhoa carambola</i>	Oxalidaceae	Butt's Dwarf	A3, B3
17918	<i>Averrhoa carambola</i>	Oxalidaceae	Fwang Tung	B2
17931	<i>Philodendron bipinnatifidum</i>	Araceae	-	C2
17935	<i>Plumbago auriculata</i>	Plumbaginaceae	Cape Leadwort	C2
17939	<i>Chrysophyllum cainito</i>	Sapotaceae	Star Apple	SH
17942	<i>Heliconia caribaea</i>	Heliconiaceae	Macaw Flower	D2
17951	<i>Musa ornata</i>	Musaceae	Flowering banana	C1
17972	<i>Brugmansia x candida</i>	Solanaceae	Angel's Trumpet	C3
17980	<i>Chrysophyllum oliviforme</i>	Sapotaceae	Satin Leaf Tree	B2
17982	<i>Crossandra infundibuliformis</i>	Acanthaceae	Firecracker Flower	C2
17986	<i>Theobroma cacao</i>	Malvaceae	White Cocoa	A3
17987	<i>Artocarpus</i> sp.	Moraceae	-	A3
17988	<i>Artocarpus</i> sp.	Moraceae	-	A3
17989	<i>Artocarpus lacucha</i>	Moraceae	Lakoocha	A3
17990	<i>Artocarpus altilis</i>	Moraceae	Samoa	C1

General Inventory - E1 (Plots 5-12)

TARS No.	Binomial	Family	Common Name	Location
17991	<i>Heliconia platystachys</i>	Heliconiaceae	'Sexy Orange'	A3, C2
17992	<i>Musa hybrid</i>	Musaceae	Thousand Fingers	C2
17994	<i>Allamanda cathartica</i>	Apocynaceae	'Double'	SH
18004	<i>Plumeria pudica</i>	Apocynaceae	Bridal Bouquet	C2
18015	<i>Herrania umbratica</i>	Malvaceae	Herrania	C1
18029	<i>Cymbopogon citratus</i>	Poaceae	Lemon Grass	C2
18038	<i>Alpinia purpurata</i>	Zingiberaceae	Pink Ginger	C3
18044	<i>Musa velutina</i>	Musaceae	Pink Velvet Banana	B2, C2
18073	<i>Brugmansia x candida</i>	Solanaceae	Angel's Trumpet	C3
18091	<i>Cnidoscolus aconitifolius</i>	Euphorbiaceae	Chaya	SH
18092	<i>Artocarpus hypargyreus</i>	Moraceae	Bai Gui Mu	C1
18099	<i>Calathea allouia</i>	Marantaceae	Guinea Arrowroot	SH
18100	<i>Zingiber officinale</i>	Zingiberaceae	Common Ginger	SH
18101	<i>Maranta arundinacea</i>	Marantaceae	Arrowroot	SH
18103	<i>Alocasia x amazonica</i>	Araceae	Elephant's Ear	SH
18106	<i>Brugmansia sp.</i>	Solanaceae	Angel's Trumpet (Pink)	C3
18150	<i>Passiflora quadrangularis</i>	Passifloraceae	Giant Passionfruit	SH
18152	<i>Pogonatherum paniceum</i>	Poaceae	Miniature Bamboo	D2
18153	<i>Hedychium coronarium</i>	Zingiberaceae	White Ginger	C3
18154	<i>Hedychium flavum</i>	Zingiberaceae	Yellow Ginger	B4
18156	<i>Vanilla pompona</i>	Orchidaceae	Pompona Vanilla	SH
18157	<i>Musa coccinea</i>	Musaceae	Scarlet Banana	D1
18166	<i>Curcuma sp.</i>	Zingiberaceae	Curcuma	SH
18191	<i>Theobroma cacao</i>	Malvaceae	Round Leaf Cacao	B2
18192	<i>Theobroma bicolor</i>	Malvaceae	Tiger Cocoa	B2
18193	<i>Theobroma grandiflorum</i>	Malvaceae	Cupuaçu	B2
18194	<i>Theobroma angustifolium</i>	Malvaceae	Mountain Cocoa	B2
18196	<i>Herrania sp.</i>	Malvaceae	Herrania sp. #1	B1
18197	<i>Herrania sp.</i>	Malvaceae	Herrania sp. #2	B2
18259	<i>Theobroma gileri</i>	Malvaceae	-	C1
18260	<i>Passiflora edulis</i>	Passifloraceae	Purple Passionfruit	SH
18266	<i>Herrania pulcherima</i>	Malvaceae	Herrania	C1
18267	<i>Herrania purpurea</i>	Malvaceae	Herrania	B1
18296	<i>Calathea allouia</i>	Marantaceae	Guinea arrowroot	SH
18297	<i>Curcuma longa</i>	Zingiberaceae	Primavera	SH
18298	<i>Alocasia macrorrhizos</i>	Araceae	Variiegated Sport	SH
18309	<i>Musa laterita</i>	Musaceae	Bronze Banana	C1

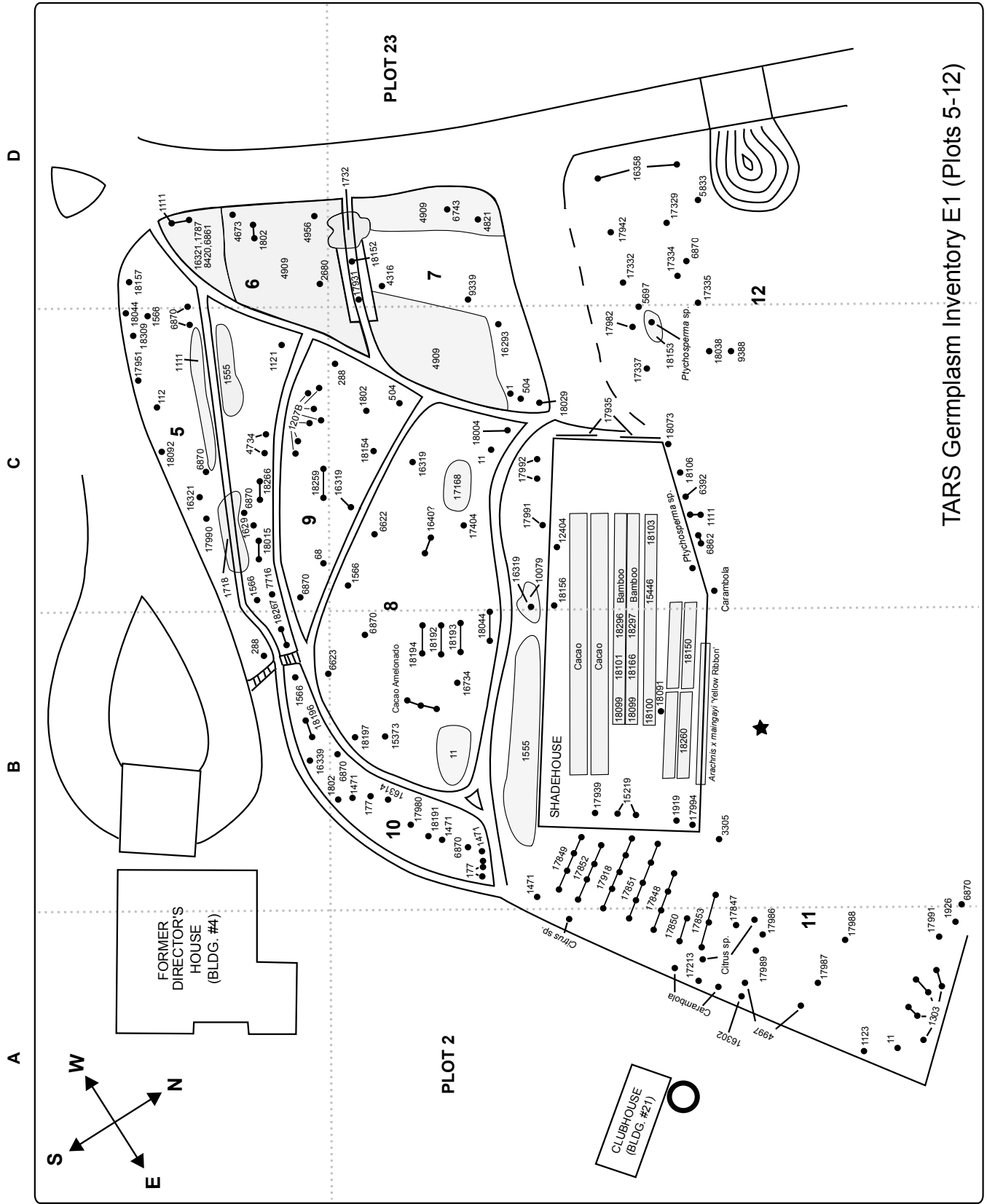

TARS Germplasm Inventory E1 (Plots 5-12)

★ GPS Coordinates: N 18°12.495 W 67°08.224

General Inventory - E1 (Plots 13-15)

TARS No.	Binomial	Family	Common Name	Location
229	<i>Swietenia mahagoni</i>	Meliaceae	West Indian Mahogany	A2, A3
1111	<i>Codiaeum variegatum</i>	Euphorbiaceae	Croton, Periquito	A2, A3
1202	<i>Garcinia mangostana</i>	Clusiaceae	Mangosteen	A2, A3, B2
1345	<i>Lagerstroemia speciosa</i>	Lythraceae	Queen Crape Myrtle	A1
1452	<i>Ficus nota</i>	Moraceae	-	C1
1524	<i>Ptychosperma</i> sp.	Arecaceae	-	B3
1782	<i>Litchi chinensis</i>	Sapindaceae	Lychee	C2
2076	<i>Morus alba</i>	Moraceae	Mulberry	A1
2105	<i>Ruprechtia ramiflora</i>	Polygonaceae	Guayabo Volador	C1
2428	<i>Bactris gasipaes</i> var. <i>gasipaes</i>	Arecaceae	Peach Palm	B3
3108	<i>Syzygium cumini</i>	Myrtaceae	Jambolan	B1
3283	<i>Byrsonima crassifolia</i>	Malpighiaceae	Craboo	C1
3731	<i>Holoptelea integrifolia</i>	Ulmaceae	Indian Elm	A2
4890	<i>Polyscias guilfoylei</i>	Araliaceae	Geranium Aralia	B2
5881	<i>Gmelina asiatica</i>	Verbenaceae	Asian Bushbeech	C2
6511	<i>Ardisia solanacea</i>	Myrsinaceae	Shoebuttan Ardisia	A2
6805	<i>Livistona</i> sp.	Arecaceae	Swamp Anahan	B3
6909	<i>Livistona</i> sp.	Arecaceae	Swamp Anahan	B3
6936	<i>Ixora coccinea</i>	Rubiaceae	Orange Ixora	B1, B2
7502	<i>Averrhoa carambola</i>	Oxalidaceae	Starfruit	A2
8340	<i>Pterocarpus indicus</i>	Fabaceae	Padouk	C3
8737	<i>Syzygium cumini</i>	Myrtaceae	Longboy	B3
8944	<i>Uvaria rufa</i>	Annonaceae	Calabao	A2, A3
9388	<i>Cheilocostus speciosus</i>	Costaceae	Crepe Ginger	B4
9515	<i>Etilingera elatior</i>	Zingiberaceae	Red Torch Ginger	C2
9560	<i>Vanilla planifolia</i>	Orchidaceae	Mexican Vanilla	GH-8
9949	<i>Tabernaemontana divaricata</i>	Apocynaceae	Crepe Jasmine	B1, B2
10172	<i>Philodendron domesticum</i> x <i>wendlandii</i>	Araceae	-	A2
15446	<i>Amorphophallus paeoniifolius</i>	Araceae	Elephant Yam	B2
16020	<i>Averrhoa carambola</i>	Oxalidaceae	'Light Yellow Fruit'	A3
16288	<i>Barringtonia</i> sp.	Lecythidaceae	Pau Nuts	B3
16292	<i>Bambusa vulgaris</i>	Poaceae	'Vitatta'	B4
16439	<i>Phyllostachys purpurata</i> 'Solidstem'	Poaceae	Shui Chuk	B4
16441	<i>Phyllostachys dulcis</i>	Poaceae	Sweetshoot Bamboo	B3
16442	<i>Phyllostachys nigra</i>	Poaceae	Black Bamboo	B3
16443	<i>Phyllostachys nigra</i> 'Hale'	Poaceae	Black Bamboo	B3
16444	<i>Arundinaria hindsii</i>	Poaceae	Ram-rod Bamboo	B4
16447	<i>Sinobambusa</i> sp.	Poaceae	-	B3
16448	<i>Phyllostachys arcana</i>	Poaceae	Half-Black Bamboo	B3
16449	<i>Phyllostachys aureosulcata</i>	Poaceae	Yellow-Groove Bamboo	B4
16450	<i>Phyllostachys bambusoides</i>	Poaceae	Giant Timber Bamboo	B4
16452	<i>Phyllostachys mannii</i>	Poaceae	Foo (Wong) Chuk	B4

General Inventory - E1 (Plots 13-15)

TARS No.	Binomial	Family	Common Name	Location
16453	<i>Phyllostachys elegans</i>	Poaceae	Elegant Bamboo	B3
16454	<i>Phyllostachys flexuosa</i>	Poaceae	Qu gan zhu	B3
16455	<i>Phyllostachys glauca</i>	Poaceae	Fa chua, ting chaa chow	B4
16456	<i>Phyllostachys nidularia</i>	Poaceae	Lak cha chuk	B4
16457	<i>Phyllostachys nidularia</i>	Poaceae	Kam Sz Chuk	B4
16458	<i>Phyllostachys nigra</i> 'Henon'	Poaceae	Henon Bamboo	B3
16459	<i>Phyllostachys rubromarginata</i>	Poaceae	Ka fat to chuk	A4
16460	<i>Pseudosasa japonica</i>	Poaceae	Arrow Bamboo	B3, B4
16461	<i>Semiarundinaria fastuosa</i>	Poaceae	Narihira Bamboo	B4
16462	<i>Sinobambusa</i> sp.	Poaceae	TRS-2524	B3
16463	<i>Pseudosasa cantorii</i>	Poaceae	TRS-2501	B3
16464	<i>Phyllostachys aureosulcata</i>	Poaceae	S-2765	B4
16465	<i>Phyllostachys bambusoides</i>	Poaceae	Slender Crookstem	B4
16467	<i>Phyllostachys flexuosa</i>	Poaceae	Drooping Timber Bamboo	B4
16468	<i>Phyllostachys makinoi</i>	Poaceae	Makino Bamboo	B4
16469	<i>Phyllostachys meyeri</i>	Poaceae	Meyer Bamboo	B4
16470	<i>Phyllostachys nidularia</i>	Poaceae	Kan chuk	B4
16471	<i>Phyllostachys nigra</i> 'Henon'	Poaceae	Henon Bamboo	B4
16473	<i>Phyllostachys nuda</i>	Poaceae	Nude Sheath Bamboo	B3
16474	<i>Phyllostachys purpurata</i> 'Straightstem'	Poaceae	Shat sam chuk, mah chuk	B4
16475	<i>Phyllostachys purpurata</i> 'Straightstem'	Poaceae	Chung Chuk	B4
16476	<i>Phyllostachys purpurata</i> 'Straightstem'	Poaceae	Mu'k Chuk	B4
16477	<i>Phyllostachys rubromarginata</i>	Poaceae	Red Margin Bamboo	B3
16478	<i>Phyllostachys sulphurea</i> var. <i>viridis</i>	Poaceae	Robert Young Bamboo	B4
16479	<i>Phyllostachys bambusoides</i>	Poaceae	Kwai chuk	B4
16480	<i>Phyllostachys angusta</i>	Poaceae	Sah tsoh	B3
16481	<i>Phyllostachys aurea</i>	Poaceae	Golden Bamboo	B3
16482	<i>Phyllostachys bambusoides</i>	Poaceae	Giant Timber Bamboo	B3
16484	<i>Phyllostachys bissetii</i>	Poaceae	David Bisset's Bamboo	B3
16485	<i>Phyllostachys nigra</i>	Poaceae	Black Bamboo	B3
16486	<i>Phyllostachys purpurata</i> 'Typical'	Poaceae	Lai Tsai Chuk	B3
16487	<i>Phyllostachys purpurata</i> 'Straightstem'	Poaceae	Wongtun chuk	B4
16488	<i>Bambusa multiplex</i>	Poaceae	Hedge Bamboo	B3
16489	<i>Bambusa multiplex</i> 'Alphonse Kar'	Poaceae	Alphonse Karr Bamboo	A4
16490	<i>Bambusa multiplex</i> 'Silverstripe'	Poaceae	Silver Stripe	A3
16491	<i>Bambusa multiplex</i> 'Riviereorum'	Poaceae	Koon yam chuk	A4
16493	<i>Phyllostachys aurea</i> 'Belgium'	Poaceae	Golden Bamboo	A4
16496	<i>Phyllostachys nidularia</i> 'Smoothsheath'	Poaceae	Chan Chuk	B3
16497	<i>Phyllostachys nigra</i> 'Bory'	Poaceae	Bory	B3
16498	<i>Phyllostachys purpurata</i>	Poaceae	Poon Chuk	B4
16499	<i>Phyllostachys purpurata</i> 'Solidstem'	Poaceae	Muk Chuk	B3
16500	<i>Phyllostachys rubromarginata</i>	Poaceae	Red Margin Bamboo	B3

General Inventory - E1 (Plots 13-15)

TARS No.	Binomial	Family	Common Name	Location
16501	<i>Phyllostachys sulphurea</i> var. <i>viridis</i>	Poaceae	Green Sulphur Bamboo	B3
16502	<i>Pleioblastus simonii</i>	Poaceae	Simon Bamboo	A4
16503	<i>Sinobambusa</i> sp.	Poaceae	TRS-2523	B3
16504	<i>Sinobambusa</i> sp.	Poaceae	TRS-2527	B3
17119	<i>Bambusa textilis</i>	Poaceae	Weaver's Bamboo	A3
17279	<i>Phyllostachys aureosulcata</i> 'Harbin'	Poaceae	Harbin	A3
17283	<i>Pleioblastus viridistriata</i>	Poaceae	Dwarf Greenstripe Bamboo	B3
17284	<i>Arundinaria oleosa</i>	Poaceae	-	A3
17285	<i>Indocalamus solidus</i>	Poaceae	-	A4
17722	<i>Phyllostachys bambusoides</i> 'All Gold'	Poaceae	All Gold Bamboo	A3
17723	<i>Shibataea kumasaca</i>	Poaceae	Ruscus-leaf Bamboo	A4
17724	<i>Pleioblastus fortunei</i>	Poaceae	Pigmy Bamboo	GH-8
17725	<i>Pleioblastus distichus</i>	Poaceae	Dwarf Fernleaf Bamboo	GH-8
17727	<i>Brachystachyum densiflorum</i>	Poaceae	-	B3
17929	<i>Bactris gasipaes</i>	Arecaceae	Peach Palm	B3
17935	<i>Plumbago auriculata</i>	Plumbaginaceae	Cape Leadwort	B1
17938	<i>Bixa orellana</i>	Bixaceae	Annatto	C2
17943	<i>Heliconia psittacorum</i>	Heliconiaceae	Parrot's Flower	B1
17954	<i>Peltophorum pterocarpum</i>	Fabaceae	Yellow Poinciana	C3
17957	<i>Russelia equisetiformis</i>	Plantaginaceae	Coral Plant	A2
17960	<i>Phyllostachys bambusoides</i>	Poaceae	Mui Tim Chuk	A4
17970	<i>Ficus pseudopalma</i>	Moraceae	Dracaena Fig	B3
17971	<i>Arachis glabrata</i>	Fabaceae	Ornamental Peanut	B2
17974	<i>Ixora</i> sp.	Rubiaceae	Pink Ixora	A2, B1, B2
17976	<i>Ixora</i> sp.	Poaceae	Red Ixora	A2
17978	<i>Pleioblastus chino</i>	Poaceae	Vaginatus Variegatus	A4
17984	<i>Epiphyllum oxypetalum</i>	Cactaceae	Dutchman's-pipe Cactus	A3
18000	<i>Garcinia madruno</i>	Clusiaceae	Madroño	B2
18009	<i>Artocarpus altilis</i>	Moraceae	Seeded Breadfruit	C3
18040	<i>Oncoba spinosa</i>	Salicaceae	Fried Egg Tree	A2
18041	<i>Heliconia bihai</i>	Heliconiaceae	Orange Variety	A4
18042	<i>Heliconia platystachys</i>	Heliconiaceae	Sexy Orange	A3
18043	<i>Heliconia</i> sp.	Heliconiaceae	Guyana	A3
18057	<i>Musa acuminata</i>	Musaceae	Siam Ruby	B3
18089	<i>Clerodendrum quadriloculare</i>	Lamiaceae	Starburst	B1
18095	<i>Piper nigrum</i>	Piperaceae	'Balancotta'	A2, GH-8
18105	<i>Brugmansia</i> sp.	Solanaceae	Angel's Trumpet (White)	B4
18146	<i>Vanilla planifolia</i>	Orchidaceae	Variegated Vanilla	GH-8
18147	<i>Vanilla pompona</i>	Orchidaceae	Pompona Vanilla	GH-8
18158	<i>Canna indica</i>	Cannaceae	Mapuey	A2
18160	<i>Asclepias curassavica</i>	Apocynaceae	Milkweed	B1
18161	<i>Coix lacryma-jobi</i>	Poaceae	Job's Tears	GH-8

General Inventory - E1 (Plots 13-15)

TARS No.	Binomial	Family	Common Name	Location
18163	<i>Mansoa alliacea</i>	Bignoniaceae	Garlic Vine	A2
18258	<i>Theobroma</i> sp.	Malvaceae	San Lorenzo	GH-8
18263	<i>Agave americana</i>	Asparagaceae	Silver Variety	B1
18269	<i>Hibiscus tiliaceus</i>	Malvaceae	Coast Hibiscus	E2
18270	<i>Clerodendrum thomsoniae</i>	Lamiaceae	Pink Bleeding Heart	C1
18291	<i>Garcinia hombroniana</i>	Clusiaceae	Seashore Mangosteen	A3
18293	<i>Garcinia magnifolia</i>	Clusiaceae	Madroño liso	A2
18308	<i>Garcinia brasiliensis</i>	Clusiaceae	Bakupari	A2

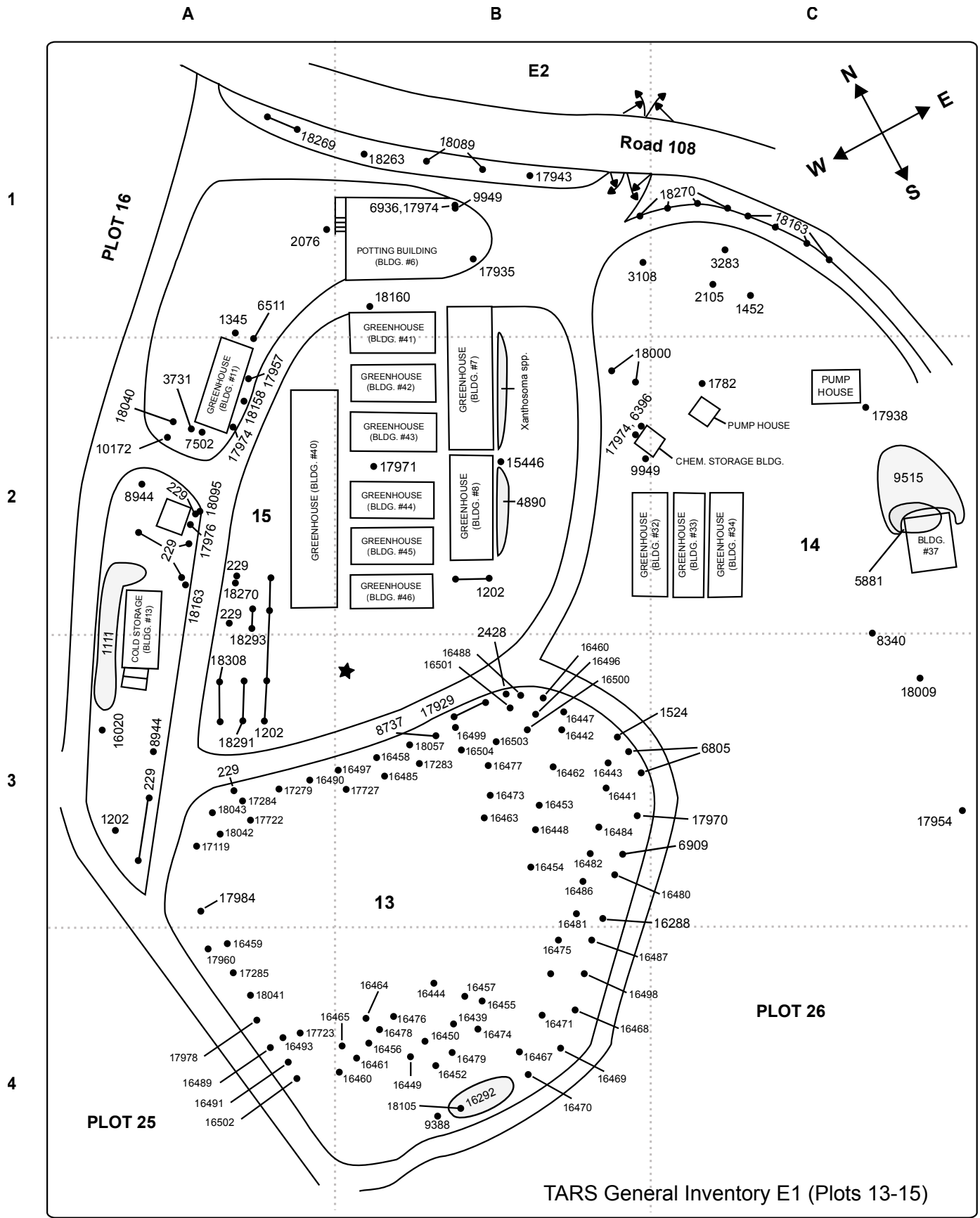

General Inventory - E1 (Plot 16)

TARS No.	Binomial	Family	Common Name	Location
16	<i>Alstonia macrophylla</i>	Apocynaceae	Batino, Hard Alstonia	A2
25	<i>Brownea grandiceps</i>	Fabaceae	Venezuelan Rose	A2
29	<i>Crescentia cujete</i>	Bignoniaceae	Calabash Tree	B2
69	<i>Delonix regia</i>	Fabaceae	Flamboyant Tree	D1
229	<i>Swietenia mahagoni</i>	Meliaceae	West Indian Mahogany	C2
1471	<i>Posoqueria latifolia</i>	Rubiaceae	Needle-flower Tree	B2
1737	<i>Cavanillesia platanifolia</i>	Malvaceae	Panama Canoe Tree	B2
2070	<i>Hylocereus trigonus</i>	Cactaceae	Night Blooming Cereus	C3
2526	<i>Carissa spinarum</i>	Apocynaceae	Carandas Plum	B1
3665	<i>Bambusa</i> sp.	Poaceae	-	C3, D3
3667	<i>Bambusa polymorpha</i>	Poaceae	Polymorph Bamboo	C3, D3
4276	<i>Calycophyllum candidissimum</i>	Rubiaceae	Dagame	C1
4616	<i>Brownea macrophylla</i>	Fabaceae	-	B2, D2
4991	<i>Corymbia citriodora</i>	Myrtaceae	Citron-scent Gum	C1, C2
4997	<i>Pachira aquatica</i>	Malvaceae	Guiana Chestnut	C2
5001	<i>Cola acuminata</i>	Malvaceae	Kola Nut	B2
6503	<i>Dolichandra unguis-cati</i>	Bignoniaceae	Cat's Claw	C2
6604	<i>Nauclea orientalis</i>	Rubiaceae	African Peach	C1
6813	<i>Garcinia benthamii</i>	Clusiaceae	-	C1
6870	<i>Roystonea borinquena</i>	Arecaceae	Puerto Rican Royal Palm	B2
7136	<i>Alstonia scholaris</i>	Apocynaceae	Devil Tree	A2
7716	<i>Triphasia trifolia</i>	Rutaceae	Jerusalem Lemon	C2
8863	<i>Swinglea glutinosa</i>	Rutaceae	Tabog	C2
10143	<i>Diospyros digyna</i>	Ebenaceae	Black Sapote	C2
13309	<i>Aegle marmelos</i>	Rutaceae	Bael Fruit	C1, D1
14677	<i>Sandoricum koetjape</i>	Meliaceae	Red Santol, Donka	C2
16300	<i>Clusia major</i>	Clusiaceae	Cupey	C2
16366	<i>Cassia bakeriana</i>	Fabaceae	Baker's Shower Tree	C3
17945	<i>Delonix regia</i>	Fabaceae	Flamboyant Tree	C3
17985	<i>Nephelium ramboutan-ake</i>	Sapindaceae	Pulasan	C3
17999	<i>Annona mucosa</i>	Annonaceae	Wild Sweetsop	D2
18001	<i>Chrysobalanus icaco</i>	Chrysobalanaceae	Icaco Rosado	D2
18002	<i>Artocarpus heterophyllus</i>	Moraceae	Jackfruit, Jaca	C2
18003	<i>Licania platypus</i>	Chrysobalanaceae	Sansapote	C2
18004	<i>Plumeria pudica</i>	Apocynaceae	Bridal Bouquet	A2
18008	<i>Phyllanthus acidus</i>	Euphorbiaceae	Gooseberry	A2, B2, C2
18016	<i>Pouteria glomerata</i> subsp. <i>glomerata</i>	Sapotaceae	Choch	B1
18083	<i>Jatropha curcas</i>	Euphorbiaceae	Tartago	B2
18199	<i>Uvaria ovata</i>	Annonaceae	-	C2
18268	<i>Borojoa patinoi</i>	Rubiaceae	Borojo	B1



TARS Germplasm Inventory E1 (Plot 16)

★ GPS Coordinates: N 18°12.584 W 67°08.242

General Inventory - E1 (Plot 17)

TARS No.	Binomial	Family	Common Name	Location
62	<i>Ravenala madagascariensis</i>	Strelitziaceae	Traveler's Palm	B1
64	<i>Yucca aloifolia</i>	Agavaceae	Spanish Bayonet	C3
229	<i>Mangifera indica</i>	Anacardiaceae	Mango	C3
288	<i>Swietenia macrophylla</i>	Meliaceae	Honduras Mahogany	B2, B3
747	<i>Cananga odorata</i>	Annonaceae	Ilang-Ilang	C3
1111	<i>Codiaeum variegatum</i>	Euphorbiaceae	Croton, Periquito	A2, C3
1327	<i>Eucalyptus</i> sp.	Myrtaceae	Flooded Gum	C3
1345	<i>Lagerstroemia speciosa</i>	Lythraceae	Queen Crape Myrtle	A2, B1
1471	<i>Posoqueria latifolia</i>	Rubiaceae	Needle-flower Tree	D1
1737	<i>Cavanillesia platanifolia</i>	Malvaceae	Panama Canoe Tree	C3
1744	<i>Pandanus dubius</i>	Pandanaceae	Bakong	C2
2609	<i>Handroanthus chrysanthus</i>	Bignoniaceae	Roble Amarillo	C3
2663	<i>Erythrina variegata</i>	Fabaceae	Indian Coral Tree	C3
3730	<i>Haplophragma adenophyllum</i>	Bignoniaceae	Karenwood	C3
3731	<i>Holoptelea integrifolia</i>	Ulmaceae	Indian Elm	C3
3746	<i>Terminalia superba</i>	Combretaceae	Afara	C3
4899	<i>Catalpa longissima</i>	Bignoniaceae	French Oak	C3
5001	<i>Cola acuminata</i>	Malvaceae	Kola Nut	C3
5731	<i>Schefflera actinophylla</i>	Araliaceae	Octopus Tree	C3
6005	<i>Flacourtia rukam</i>	Salicaceae	Rukam	C3
6398	<i>Ptychosperma macarthurii</i>	Arecaceae	Macarthur's Palm	C1, C2
6511	<i>Ardisia solanacea</i>	Myrsinaceae	Shoebuttan Ardisia	B1, C1
6670	<i>Pandanus copelandii</i>	Pandanaceae	Screwpine	C2
6803	<i>Leea guineensis</i>	Vitaceae	Leea	D2
6808	<i>Pandanus</i> sp.	Pandanaceae	Screw Pine	C2, D2
6870	<i>Roystonea borinquena</i>	Arecaceae	Puerto Rican Royal Palm	Several
7462	<i>Ruprechtia coriacea</i>	Polygonaceae	Guayabo Faisán	C3
8340	<i>Pterocarpus indicus</i>	Fabaceae	Padouk	D1
8582	<i>Calliandra haematocephala</i>	Fabaceae	Powder-Puff Tree	B2
8644	<i>Ficus religiosa</i>	Moraceae	Sacred Fig	C2
8860	<i>Bauhinia</i> sp.	Fabaceae	Orchid Tree	D1
13308	<i>Eriobotrya deflexa</i>	Rosaceae	Níspero Japonés	C3
14612	<i>Terminalia catappa</i>	Combretaceae	Tropical Almond	C3
16024	<i>Citrus maxima</i>	Rutaceae	Flat Dry Pink	D1
16028	<i>Citrus maxima</i>	Rutaceae	Thong Dee (White)	D1
16030	<i>Citrus maxima</i>	Rutaceae	Father Jerome	D1
16301	<i>Cocos nucifera</i>	Arecaceae	Coconut Palm	Several
16329	<i>Pinus caribaea</i>	Pinaceae	Caribbean Pine	C2
17931	<i>Philodendron bipinnatifidum</i>	Araceae	-	B1, B3
17934	<i>Syzygium malaccense</i>	Myrtaceae	Malay Apple	B3
17940	<i>Thrinax radiata</i>	Arecaceae	Silk-top Thatch Palm	B1
17969	<i>Lagerstroemia</i> sp.	Lythraceae	-	C1
18031	<i>Hibiscus elatus</i>	Malvaceae	Blue Mahoe	B3

General Inventory - E1 (Plot 17)

TARS No.	Binomial	Family	Common Name	Location
18094	<i>Leea guineensis</i> var. <i>violacea</i>	Vitaceae	-	C2
18097	<i>Genipa americana</i>	Rubiaceae	Jagua	B2
18104	<i>Phoenix roebelenii</i>	Arecaceae	Dwarf Date Palm	C1
18148	<i>Pseudobombax ellipticum</i>	Malvaceae	Shaving Brush Tree	C1
18169	<i>Malpighia emarginata</i>	Malpighiaceae	West Indian Cherry	B3
18265	<i>Citrus aurantiifolia</i>	Rutaceae	Lime	B3
18277	<i>Cocos nucifera</i>	Arecaceae	Yellow Dwarf Variety	D2
18299	<i>Mangifera indica</i>	Anacardiaceae	'Sufaida'	C2
18310	<i>Calophyllum</i> sp.	Calophyllaceae	'Variegated Form'	B2

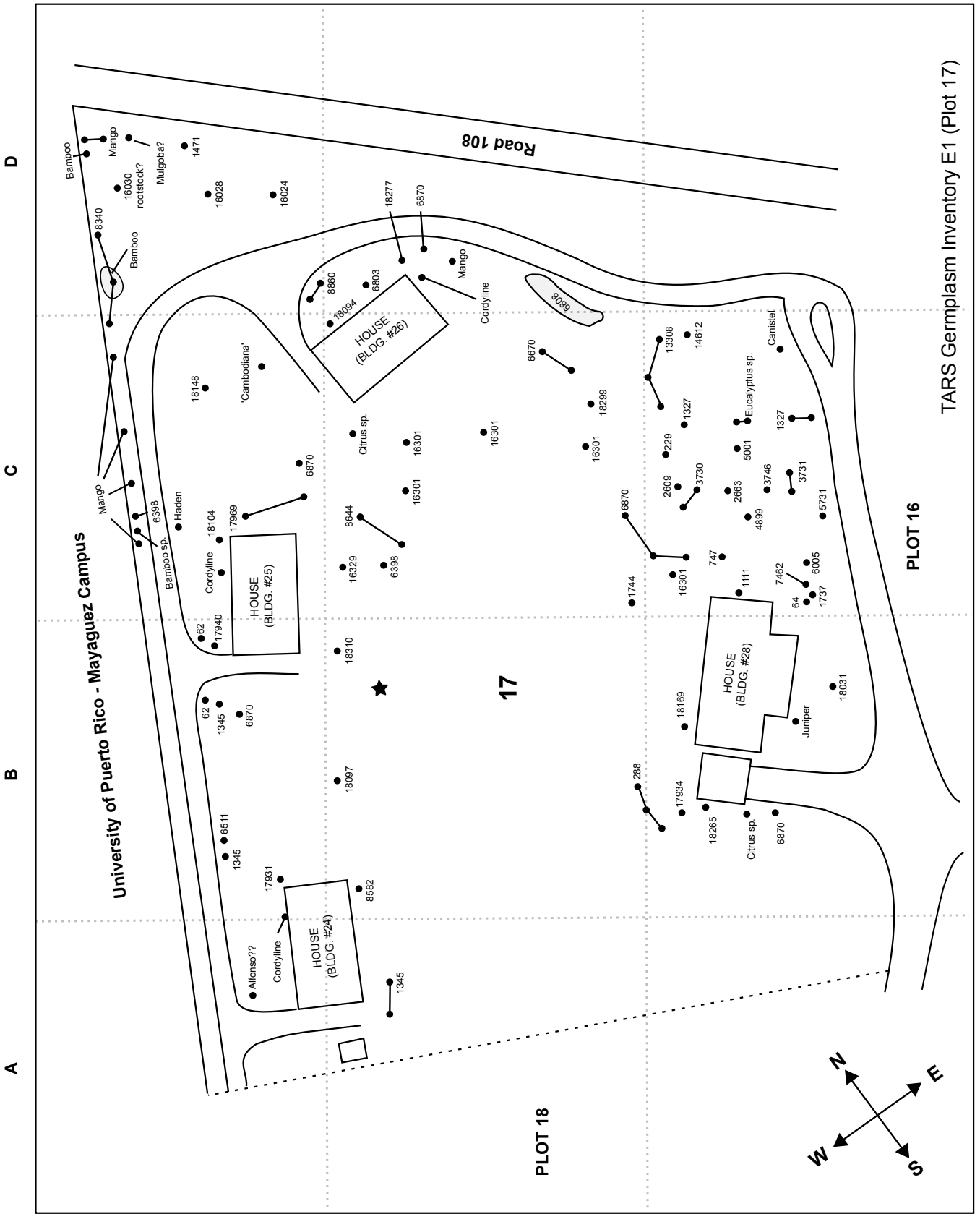

General Inventory - E1 (Plot 18)

TARS No.	Binomial	Family	Common Name	Location
62	<i>Ravenala madagascariensis</i>	Strelitziaceae	Traveler's Palm	C3
64	<i>Yucca aloifolia</i>	Agavaceae	Spanish Bayonet	A2
229	<i>Swietenia mahagoni</i>	Malvaceae	West Indian Mahogany	B2
747	<i>Cananga odorata</i>	Annonaceae	Ilang-Ilang	A2, B2
915	<i>Eugenia uniflora</i>	Myrtaceae	Surinam Cherry	C1
1111	<i>Codiaeum variegatum</i>	Euphorbiaceae	Croton, Periquito	Several
1614	<i>Elaeis guineensis</i>	Arecaceae	African Oil Palm	A2
1790	<i>Garcinia mangostana</i>	Clusiaceae	Mangosteen	C1
2371	<i>Hibiscus rosa-sinensis</i>	Malvaceae	Hibiscus	B1-2, D3
2914	<i>Areca macrocarpa</i>	Arecaceae	-	D3
4315	<i>Millettia pinnata</i>	Fabaceae	Pongam	D3
5661	<i>Ardisia solanacea</i>	Myrsinaceae	Shoebuttton Ardisia	C1
5731	<i>Schefflera actinophylla</i>	Araliaceae	Umbrella Tree	B1
6001	<i>Dypsis lutescens</i>	Arecaceae	Golden Palm	Several
6055	<i>Calliandra surinamensis</i>	Fabaceae	Surinam Powder-Puff	B2
6732	<i>Artocarpus altilis</i>	Moraceae	Breadfruit	B1
6803	<i>Leea guineensis</i>	Leeaceae	Leea	C3
6862	<i>Dracaena fragrans</i>	Dracaenaceae	-	A1
6870	<i>Roystonea borinquena</i>	Arecaceae	Puerto Rican Royal Palm	Several
8167	<i>Adonidia merrillii</i>	Arecaceae	Manila Palm	C2, D2, D3
8342	<i>Murraya paniculata</i>	Rutaceae	Orange Jessamine	C3
8683	<i>Kigelia africana</i>	Bignoniaceae	Sausage tree	A1, B1, C1
9949	<i>Tabernaemontana divaricata</i>	Apocynaceae	Crepe Jasmine	D3
16301	<i>Cocos nucifera</i>	Arecaceae	Coconut Palm	Several
16349	<i>Anacardium occidentale</i>	Anacardiaceae	Cashew	D3
16489	<i>Bambusa multiplex</i>	Poaceae	Alphonse Kar	C1
17931	<i>Philodendron bipinnatifidum</i>	Araceae	-	A2
17940	<i>Thrinax radiata</i>	Arecaceae	Silk-top Thatch Palm	B1
17943	<i>Heliconia psittacorum</i>	Heliconiaceae	Parrot's Flower	C3
17947	<i>Mussaenda frondosa</i>	Rubiaceae	-	A2, D3
17973	<i>Ixora</i> sp.	Rubiaceae	Yellow Dwarf	B2
17977	<i>Ixora</i> sp.	Rubiaceae	Orange Dwarf	A2
18036	<i>Spondias mombin</i>	Anacardiaceae	Hog Plum	D3
18071	<i>Psidium guajava</i>	Myrtaceae	N-05-6	A1
18154	<i>Hedychium flavum</i>	Zingiberaceae	Yellow Ginger	B4
18181	<i>Psidium friedrichsthalianum</i>	Myrtaceae	Cas	A2
18182	<i>Psidium friedrichsthalianum</i>	Myrtaceae	Cas	A2
18184	<i>Psidium guajava</i>	Myrtaceae	Perla	A1
18264	<i>Magnolia</i> sp.	Magnoliaceae	Magnolia	B2
18265	<i>Citrus aurantiifolia</i>	Rutaceae	Lime	Several
18271	<i>Annona muricata</i>	Annonaceae	Pedro #1	B2
18272	<i>Annona muricata</i>	Annonaceae	Pedro #2	B2
18273	<i>Annona muricata</i>	Annonaceae	Soursop	B2

General Inventory - E1 (Plot 18)

TARS No.	Binomial	Family	Common Name	Location
18277	<i>Cocos nucifera</i>	Areaceae	Yellow Dwarf Variety	B2

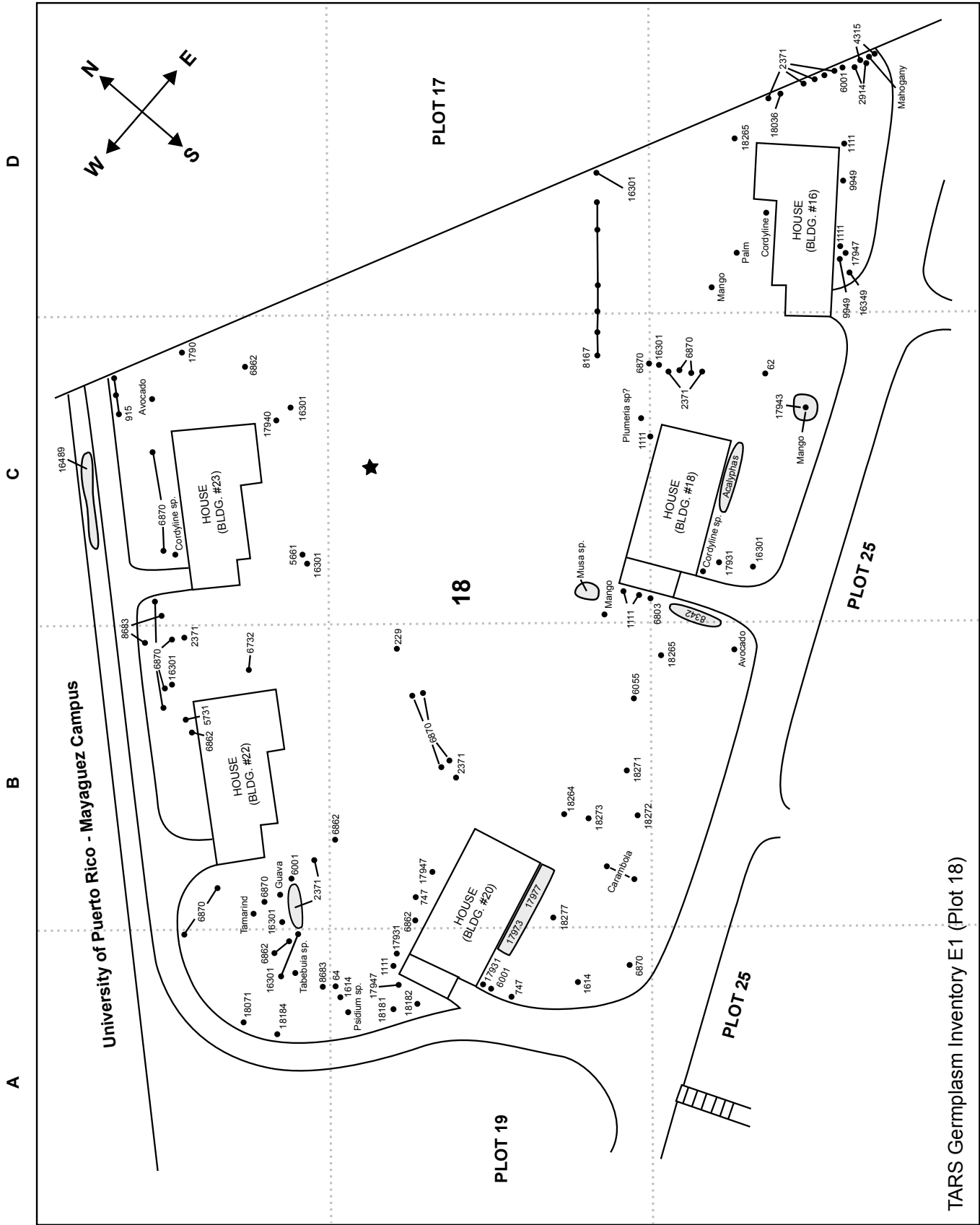

TARS Germplasm Inventory E1 (Plot 18)

★ GPS Coordinates: N 18°12.574 W 67°08.307

General Inventory - E1 (Plot 19)

TARS No.	Binomial	Family	Common Name	Location
112	<i>Pithecellobium dulce</i>	Fabaceae	Manila Tamarind	B1
229	<i>Swietenia mahagoni</i>	Meliaceae	West Indian Mahogany	B2
288	<i>Swietenia macrophylla</i>	Meliaceae	Honduras Mahogany	B2
1207A	<i>Adenanthera pavonina</i>	Fabaceae	Red Sandalwood Tree	B2
1424	<i>Triplaris cumingiana</i>	Polygonaceae	Ant Tree	B2
1566	<i>Artocarpus heterophyllus</i>	Moraceae	Jackfruit, Jaca	B2
1782	<i>Litchi chinensis</i>	Sapindaceae	Lychee	C2
1802	<i>Corypha umbraculifera</i>	Arecaceae	Talipot Palm	A2
1922	<i>Combretum indicum</i>	Combretaceae	Ragoon Creeper	C2
2523	<i>Cinnamomum camphora</i>	Lauraceae	Camphor Tree	D2
2609	<i>Handroanthus chrysanthus</i>	Bignoniaceae	Yellow Poui, Roble Amarillo	A2, B2
5665	<i>Parmentiera aculeata</i>	Bignoniaceae	Guajilote	B2
6005	<i>Flacourtia rukam</i>	Salicaceae	Rukam	C2
6900	<i>Ceiba pentandra</i>	Malvaceae	Kapok	C2
8342	<i>Murraya paniculata</i>	Rutaceae	Orange Jessamine	A2
8849	<i>Annona montana</i>	Annonaceae	Wild Soursop	D1, D2
15926	<i>Psidium cattleianum</i> var. <i>cattleianum</i>	Myrtaceae	Strawberry Guava	B2
15900	<i>Averrhoa bilimbi</i>	Oxalidaceae	Bilimbi	B2
16312	<i>Garcinia intermedia</i>	Clusiaceae	Cherry Mangosteen	B2
17939	<i>Chrysophyllum cainito</i>	Sapotaceae	Star Apple	C1
17996	<i>Tamarindus indica</i>	Fabaceae	Tamarind	C2
18005	<i>Colubrina elliptica</i>	Rhamnaceae	Mavi	C2
18012	<i>Brosimum alicastrum</i>	Moraceae	Mayan Breadnut	A1, A2
18072	<i>Citrus limonia</i>	Rutaceae	Volkamer Lemon	C2
18084	<i>Annona mucosa</i>	Annonaceae	Wild Sweetsop	D2
18145	<i>Tamarindus indica</i>	Fabaceae	Sweet Tamarind Seedling	C2
18169	<i>Malpighia emarginata</i>	Malpighiaceae	West Indian Chery	C2
18274	<i>Annona reticulata</i>	Annonaceae	Custard Apple	D1, D2
18275	<i>Manilkara zapota</i>	Sapotaceae	Sapodilla	C2
18289	<i>Vitex divaricata</i>	Lamiaceae	Jagueillo	B2



★ GPS Coordinates: N 18°12.517 W 67°08.354

TARS Germplasm Inventory E1 (Plot 19)

General Inventory - E1 (Plot 20)

TARS No.	Binomial	Family	Common Name	Location
11	<i>Monstera deliciosa</i>	Araceae	Ceriman	B2
64	<i>Yucca aloifolia</i>	Agavaceae	Spanish Bayonet	A4
69	<i>Delonix regia</i>	Fabaceae	Flamboyant Tree	D1
77	<i>Hibiscus rosa-sinensis</i>	Malvaceae	Variegated Hibiscus	C4
190	<i>Tabebuia heterophylla</i>	Bignoniaceae	White Cedar	A2
288	<i>Swietenia macrophylla</i>	Meliaceae	Honduras Mahogany	Several
1111	<i>Codiaeum variegatum</i>	Euphorbiaceae	Croton	B4, C3
1344	<i>Terminalia catappa</i>	Combretaceae	Tropical Almond	A4
1415	<i>Cassia javanica</i>	Fabaceae	Appleblossom Shower	B1
1417	<i>Pandanus tectorius</i>	Pandanaceae	Screw Pine	C3
1424	<i>Triplaris cumingiana</i>	Polygonaceae	Ant Tree	B1
1435	<i>Terminalia muelleri</i>	Combretaceae	Mueller's Terminalia	A4, C1, C2
1614	<i>Elaeis guineensis</i>	Arecaceae	African Oil Palm	C3
1566	<i>Artocarpus heterophyllus</i>	Moraceae	Jackfruit	B2
1778	<i>Ficus benjamina</i>	Moraceae	Benjamin's Fig	C3
1818	<i>Bombax ceiba</i>	Malvaceae	Indian Kapok	A2, B1
1819	<i>Caryota urens</i>	Arecaceae	Giant Fishtail Palm	B3
1856	<i>Triplaris americana</i>	Polygonaceae	Longhorn Ant Tree	C4
2351	<i>Hibiscus rosa-sinensis</i>	Malvaceae	Common Hibiscus	B2
2680	<i>Polygala cowellii</i>	Polygalaceae	Puerto Rican Violet Tree	B4
3592	<i>Agave americana</i>	Agavaceae	Century Plant	B3
4277	<i>Dombeya tiliacea</i>	Malvaceae	-	B4
5731	<i>Schefflera actinophylla</i>	Araliaceae	Umbrella Tree	B4
6869	<i>Erythrina fusca</i>	Fabaceae	Purple Coral-Tree	B4
6900	<i>Ceiba pentandra</i>	Malvaceae	Kapok	B1
6904	<i>Freycinetia multiflora</i>	Pandanaceae	Flowering Pandanus	A4
7251	<i>Antidesma bunius</i>	Euphorbiaceae	Salamander Tree, Bignay	A3
8167	<i>Adonidia merrillii</i>	Arecaceae	Manila Palm	B1
8340	<i>Pterocarpus indicus</i>	Fabaceae	Padouk	C3
8722	<i>Ochna mossambicensis</i>	Ochnaceae	Carnival Bush	B4
9949	<i>Tabernaemontana divaricata</i>	Apocynaceae	Crepe Jasmine	C2
9869	<i>Simarouba glauca</i>	Simaroubaceae	Paradise Tree	C2
10174	<i>Pandanus tectorius</i>	Pandanaceae	Variegated Pandanus	B3
14677	<i>Sandoricum koetjape</i>	Meliaceae	Santol	C2
15353	<i>Bauhinia</i> sp.	Fabaceae	Orchid Tree	B1
15526	<i>Jacaranda</i> sp.	Bignoniaceae	Jacaranda	B4
15896	<i>Terminalia kaernbachii</i>	Combretaceae	Okari Nut	A4
16291	<i>Azadirachta indica</i>	Meliaceae	Neem	B3
16304	<i>Combretum</i> sp.	Combretaceae	-	B3
16330	<i>Podocarpus macrophyllus</i>	Podocarpaceae	Japanese Jew	C2
17335	<i>Alpinia zerumbet</i>	Zingiberaceae	Variegated Shell	C3
17944	<i>Cecropia peltata</i>	Cecropiaceae	Trumpet Tree	A3

General Inventory - E1 (Plot 20)

TARS No.	Binomial	Family	Common Name	Location
17955	<i>Tradescantia zebrina</i>	Commelinaceae	Wandering Jew	B3
18007	<i>Pandanus</i> sp.	Pandanaceae	-	C2
18030	<i>Goetzea elegans</i>	Solanaceae	Matabuey	B4
18078	<i>Vriesea imperialis</i>	Bromeliaceae	Imperial Bromeliad	C2
18088	<i>Senna alata</i>	Fabaceae	Ringworm Tree	B2
18180	<i>Garcinia humilis</i>	Clusiaceae	Achachairu	C2
18277	<i>Cocos nucifera</i>	Areaceae	Yellow Dwarf Variety	C3

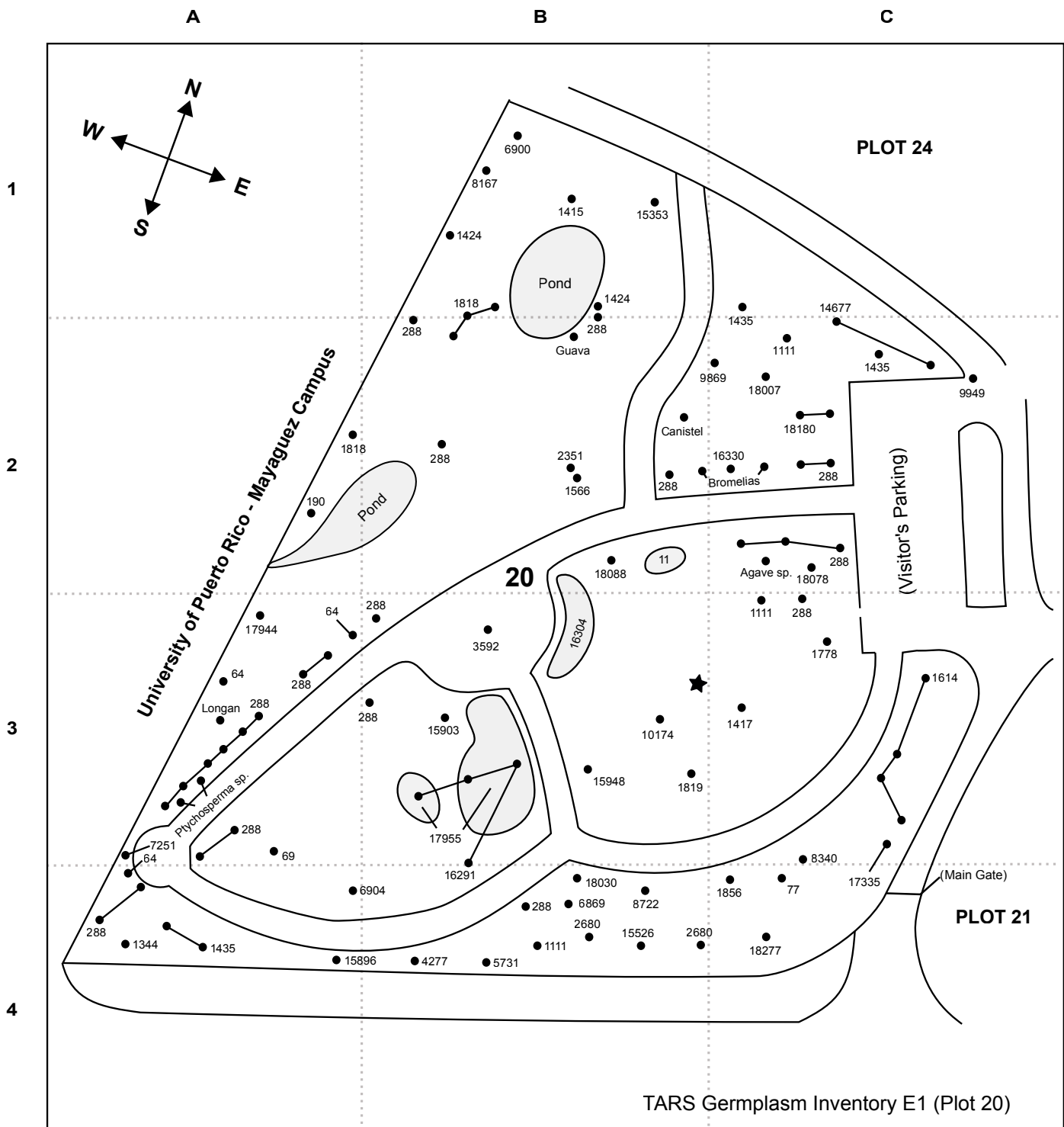

★ GPS Coordinates: N 18°12.453 W 67°08.349

General Inventory - E1 (Plot 21-23)

TARS No.	Binomial	Family	Common Name	Location
42	<i>Roystonea regia</i>	Arecaceae	Cuban Royal Palm	C1-2
70	<i>Dovyalis hebecarpa</i>	Salicaceae	Ceylon Gooseberry	C1
806	<i>Durio zibethinus</i>	Malvaceae	Durian	C1
1111	<i>Codiaeum variegatum</i>	Euphorbiaceae	Croton, Periquito	Several
1270	<i>Antidesma bunius</i>	Phyllantaceae	Salamander Tree, Bignay	C1, A2
1303	<i>Lansium domesticum</i>	Meliaceae	Langsat	A2
1614	<i>Elaeis guineensis</i>	Arecaceae	African Oil Palm	B3, C3
1625	<i>Garcinia binucao</i>	Clusiaceae	Binucao	C1
1744	<i>Pandanus dubius</i>	Pandanaceae	Bakong	C2
1777	<i>Ficus benjamina</i>	Moraceae	Benjamin Fig	A2
1783	<i>Hevea brasiliensis</i>	Euphorbiaceae	Para Rubber	C1
1787	<i>Pyrostegia venusta</i>	Bignoniaceae	Flame Vine	C1
1798	<i>Diospyros blancoi</i>	Ebenaceae	Mabolo	C3
2506	<i>Rhapis excelsa</i>	Arecaceae	Lady Elegant Palm	B1
2588	<i>Solandra grandiflora</i>	Solanaceae	Chalice Vine	B1
5620	<i>Mussaenda erythrophylla</i>	Rubiaceae	Pink Mussaenda	A2, B2, C2
5833	<i>Alpinia purpurata</i>	Zingiberaceae	Red Ginger	B2
6001	<i>Dypsis lutescens</i>	Arecaceae	Golden Palm	B1, C2
6023	<i>Epipremnum pinnatum</i>	Araceae	Aureum	B2
6398	<i>Ptychosperma macarthurii</i>	Arecaceae	Macarthur's Palm	B1, C4
6732	<i>Artocarpus altilis</i>	Moraceae	Breadfruit	C1
6870	<i>Roystonea borinquena</i>	Arecaceae	Puerto Rican Royal Palm	Several
8167	<i>Adonidia merrillii</i>	Arecaceae	Manila Palm	C2
8271	<i>Allamanda neriifolia</i>	Apocynaceae	Bush Allamanda	B3
8753	<i>Malpighia coccigera</i>	Malpighiaceae	Singapore Holly	B1
9949	<i>Tabernaemontana divaricata</i>	Apocynaceae	Crepe Jasmine	C2
16347	<i>Trimezia martinicensis</i>	Iridiaceae	Martinique Trimezia	B2
17941	<i>Gmelina philippensis</i>	Lamiaceae	Parrot's Beak	C2
17956	<i>Acalypha chamaedrifolia</i>	Euphorbiaceae	Bastard Copperleaf	B2, C2
17961	<i>Mangifera indica</i>	Anacardiaceae	Cambodiana	B1
17963	<i>Mangifera indica</i>	Anacardiaceae	Edward	C1
17966	<i>Mangifera indica</i>	Anacardiaceae	Palmer	B1
17968	<i>Mangifera indica</i>	Anacardiaceae	Keit	C1
17971	<i>Arachis glabrata</i>	Fabaceae	Ornamental Peanut	B3
17973	<i>Ixora</i> sp.	Rubiaceae	Yellow Dwarf	B3
17974	<i>Ixora</i> sp.	Rubiaceae	Pink	B2
17977	<i>Ixora</i> sp.	Rubiaceae	Orange Dwarf	B2
18102	<i>Cryptostegia grandiflora</i>	Apocynaceae	Rubber Vine	C1
18162	<i>Mussaenda erythrophylla</i>	Apocynaceae	Red Mussaenda	C2
18188	<i>Mangifera indica</i>	Anacardiaceae	Tommy Atkins	C1
18189	<i>Mangifera indica</i>	Anacardiaceae	Irwin	C1
18283	<i>Dracaena marginata</i>	Asparagaceae	Red Edge Dracaena	C2

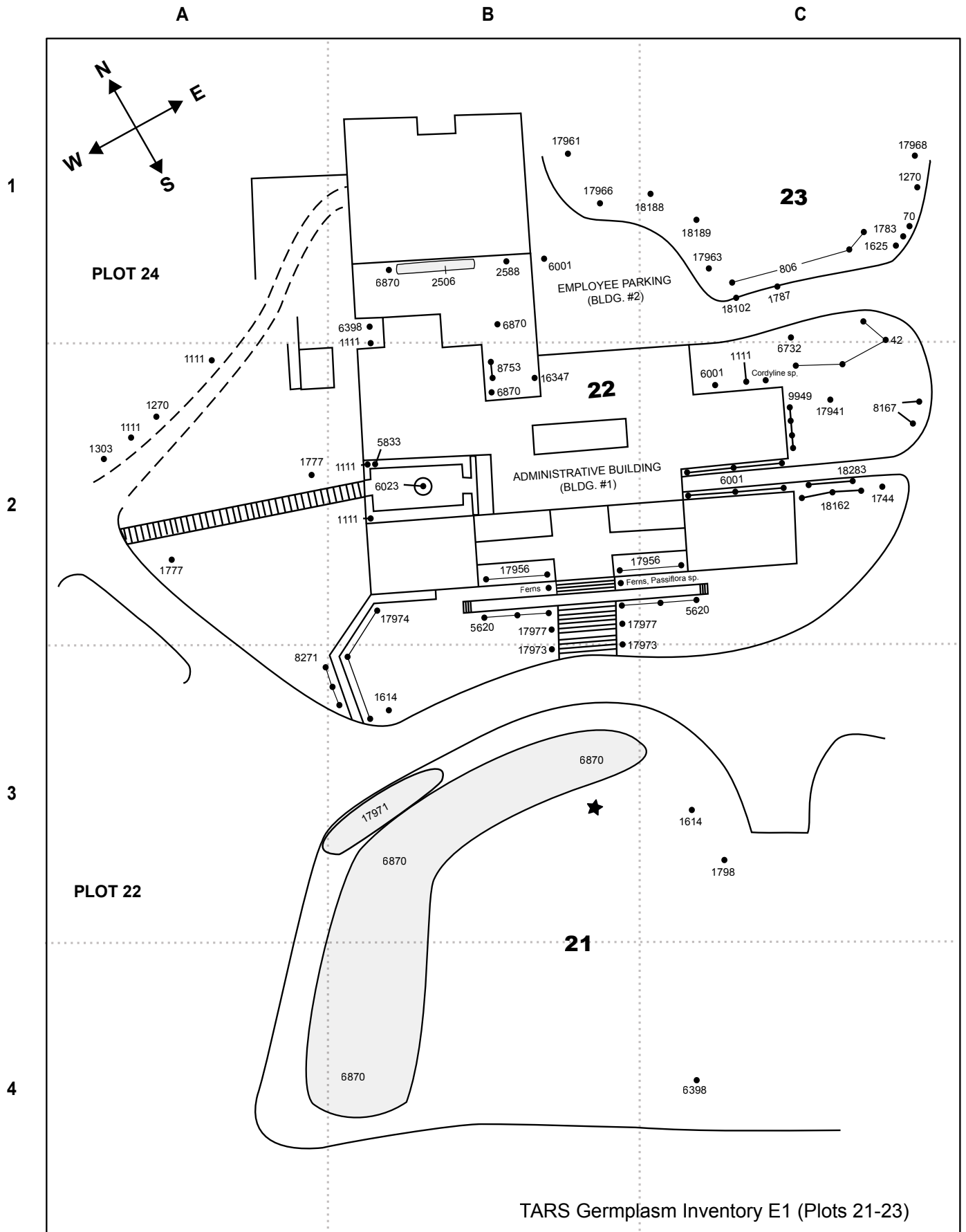

TARS Germplasm Inventory E1 (Plots 21-23)

★ GPS Coordinates: N 18°12.450 W 67°08.305

General Inventory - E1 (Plot 24)

TARS No.	Binomial	Family	Common Name	Location
223	<i>Funtumia elastica</i>	Apocynaceae	Bush Rubber, Goma	C2
1410	<i>Bambusa bambos</i>	Poaceae	Giant Thorny Bamboo	A2
1424	<i>Triplaris cumingiana</i>	Polygonaceae	Ant Tree	A2, B2
1527	<i>Dendrocalamus strictus</i>	Poaceae	Calcutta Bamboo	A3
1528	<i>Adansonia digitata</i>	Malvaceae	Baobab	A2-3
1722	<i>Bambusa ventricosa</i>	Poaceae	Buddah's Belly Bamboo	C3
1782	<i>Litchi chinensis</i>	Sapindaceae	Lychee	C1-2
1789	<i>Mascarenhasia arborescens</i>	Apocynaceae	False Rubberwood	C2
1858	<i>Calophyllum inophyllum</i>	Calophyllaceae	Alexandrian Laurel	B2
1882	<i>Bambusa tulda</i>	Poaceae	Bengal Bamboo	A3
2299	<i>Bambusa tulda</i>	Poaceae	Bengal Bamboo (old form)	A3
2301	<i>Bambusa oldhamii</i>	Poaceae	Oldham's Bamboo	C3
2485	<i>Bambusa textilis</i>	Poaceae	Weaver's Bamboo	C2
2488	<i>Bambusa longispiculata</i>	Poaceae	Tabindaing-wa	A2
2492	<i>Bambusa multiplex</i>	Poaceae	Hedge Bamboo	B3
3659	<i>Bambusa tuldooides</i>	Poaceae	Puntingpole Bamboo	B2
3666	<i>Bambusa vulgaris</i>	Poaceae	Common Bamboo	A3
3667	<i>Bambusa polymorpha</i>	Poaceae	Kyathaung-wa	B3
6050	<i>Koelreuteria elegans</i>	Sapindaceae	Flamegold	A2
6691	<i>Dendrocalamus asper</i>	Poaceae	Giant Bamboo	B3
9148	<i>Bambusa dissimulator</i>	Poaceae	Muddy Bamboo	C4
16292	<i>Bambusa vulgaris</i> var. <i>vittata</i>	Poaceae	-	A3
16489	<i>Bambusa multiplex</i>	Poaceae	Alphonse Kar Bamboo	B2
16911	<i>Melocanna baccifera</i>	Poaceae	Berry Bamboo	A2
16912	<i>Gigantochloa apus</i>	Poaceae	Watho	B3
16913	<i>Cephalostachium pergracile</i>	Poaceae	Tinwa Bamboo	B2
16914	<i>Guadua angustifolia</i>	Poaceae	Guadua	C3
18284	<i>Mangifera indica</i>	Anacardiaceae	Amini	C1
18285	<i>Bambusa lako</i>	Poaceae	Timor's Black Bamboo	B2
18286	<i>Bambusa blumeana</i>	Poaceae	Spiny Bamboo	B2
18287	<i>Cassia x nealiae</i>	Fabaceae	Rainbow Shower Tree	B2

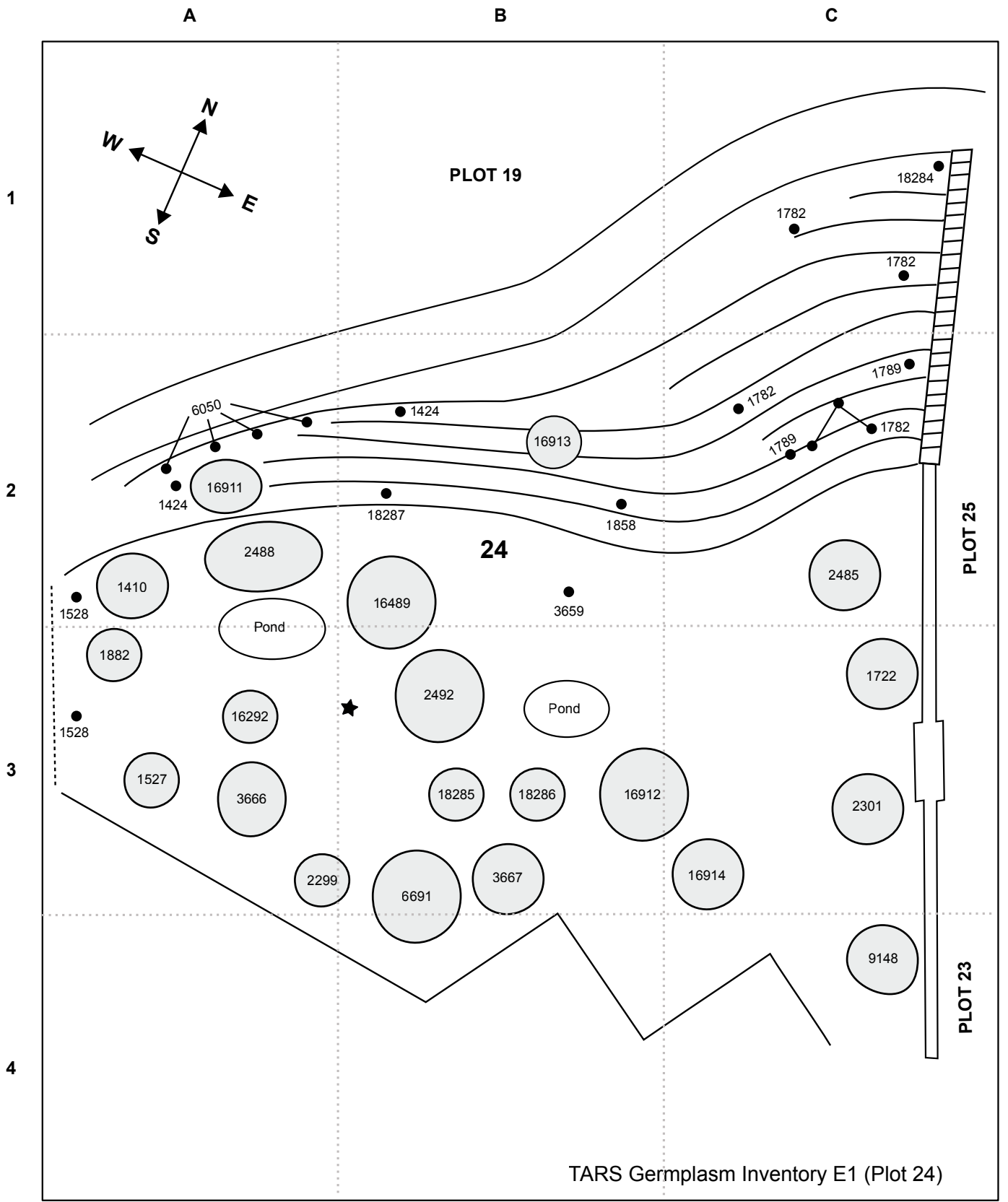

★ GPS Coordinates: N 18°12.493 W 67°08.336

General Inventory - E1 (Plot 25)

TARS No.	Binomial	Family	Common Name	Location
9	<i>Persea americana</i>	Lauraceae	Avocado	C1-2
29	<i>Crescentia cujete</i>	Bignoniaceae	Calabash Tree	C1
229	<i>Swietenia mahagoni</i>	Malvaceae	West Indian Mahogany	C1
263	<i>Parkia</i> sp.	Fabaceae	Parkia	C2
288	<i>Swietenia macrophylla</i>	Meliaceae	West Indian Mahogany	C1
747	<i>Cananga odorata</i>	Annonaceae	Ilang-Ilang	C1
806	<i>Durio zibethinus</i>	Malvaceae	Durian	B3
1049	<i>Annona purpurea</i>	Annonaceae	Negrohead	B1
1111	<i>Codiaeum variegatum</i>	Euphorbiaceae	Croton, Periquito	B1-2
1202	<i>Garcinia mangostana</i>	Clusiaceae	Mangosteen	C2
1303	<i>Lansium domesticum</i>	Meliaceae	Langsat	B3
1345	<i>Lagerstroemia speciosa</i>	Lythraceae	Queen Crape Myrtle	Several
1424	<i>Triplaris cumingiana</i>	Polygonaceae	Ant Tree	B2
1603	<i>Eugenia lineata</i>	Myrtaceae	-	B2
1611	<i>Garcinia venulosa</i>	Clusiaceae	-	B2
1632	<i>Hebestigma cubense</i>	Fabaceae	False Locust	B2
1737	<i>Cavanillesia platanifolia</i>	Malvaceae	Panama Canoe tree	C2
1782	<i>Litchi chinensis</i>	Sapindaceae	Lychee	A2
1783	<i>Hevea brasiliensis</i>	Euphorbiaceae	Para Rubber	B2
1789	<i>Mascarenhasia arborescens</i>	Apocynaceae	False Rubberwood	A2
1818	<i>Piliostigma malabaricum</i>	Fabaceae	Malabar Bauhinia	C2
1867	<i>Dimocarpus longan</i>	Sapindaceae	Longan	A2, B2
1917	<i>Malpighia emarginata</i>	Malpighiaceae	West Indian Cherry	B2
4673	<i>Pimenta racemosa</i>	Myrtaceae	Bay Rum Tree	B1
4844	<i>Lecythis minor</i>	Lecythidaceae	Monkey Pot Nut	C2
4886	<i>Acalypha hispida</i>	Euphorbiaceae	Red Hot Cat's Tail	C2
4890	<i>Polyscias guilfoylei</i>	Annonaceae	Geranium Aralia	B1
4895	<i>Callistemon citrinus</i>	Myrtaceae	Bottlebrush Tree	B1
6001	<i>Dyopsis lutescens</i>	Arecaceae	Golden Palm	A1, B1
6530	<i>Ziziphus mauritiana</i>	Rhamnaceae	Indian Jujube	C2
6862	<i>Dracaena fragrans</i>	Asparagaceae	-	C1
6870	<i>Roystonea borinquena</i>	Arecaceae	Puerto Rican Royal Palm	B1
7139	<i>Caryota</i> sp.	Arecaceae	Fishtail Palm	B1
7248	<i>Dovyalis caffra</i>	Salicaceae	Kei Apple	D2
7251	<i>Antidesma bunius</i>	Euphorbiaceae	Salamander Tree, Bignay	Several
7502	<i>Averrhoa carambola</i>	Oxalidaceae	Starfruit	C2
7806	<i>Macadamia integrifolia</i>	Proteaceae	Macadamia Nut	C2
8342	<i>Murraya paniculata</i>	Rutaceae	Orange Jessamine	B1, B2
9949	<i>Tabernaemontana divaricata</i>	Apocynaceae	Crepe Jasmine	B1
13414	<i>Dimocarpus longan</i>	Sapindaceae	Longan	D2
13866	<i>Dovyalis hebecarpa x abyssinica</i>	Salicaceae	Virrick Clone A	D2
14386	<i>Litchi chinensis</i>	Sapindaceae	Bengal	D2
16063	<i>Pouteria campechiana</i>	Sapotaceae	Simon	D1

General Inventory - E1 (Plot 25)

TARS No.	Binomial	Family	Common Name	Location
16299	<i>Chrysobalanus icaco</i>	Chrysobalanaceae	Icaco	D2
16347	<i>Trimezia martinicensis</i>	Iridiaceae	Martinique Trimezia	B2
17933	<i>Allamanda blanchetii</i>	Apocynaceae	Purple Alamanda	D1
17958	<i>Heliconia</i> sp.	Heliconiaceae	Golden Torch	D1
17962	<i>Mangifera indica</i>	Anacardiaceae	Davis Haden	B2
17964	<i>Mangifera indica</i>	Anacardiaceae	Kent	B2
17965	<i>Mangifera indica</i>	Anacardiaceae	Lippens	B2
17967	<i>Mangifera indica</i>	Anacardiaceae	Springfield	B3
17968	<i>Mangifera indica</i>	Anacardiaceae	Keit	B2
17979	<i>Terminalia catappa</i>	Combretaceae	Tropical Almond	A2
17985	<i>Nephelium ramboutan-ake</i>	Sapindaceae	Pulasan	C2
17993	<i>Kopsia fruticosa</i>	Apocynaceae	-	B1
17995	<i>Sterculia apetala</i>	Malvaceae	Anacahuita	B2
18010	<i>Cochlospermum vitifolium</i>	Bixaceae	Brazilian Rose (Double)	B1
18027	<i>Nephelium cuspidatum</i> var. <i>robustum</i>	Sapindaceae	Giant Rambutan	A1
18028	<i>Inga spectabilis</i>	Fabaceae	Guama	A1
18081	<i>Spathodea campanulata</i>	Bignoniaceae	African Tulip 'Yellow Form'	A3
18180	<i>Garcinia humilis</i>	Clusiaceae	Achachairu	B2
18265	<i>Citrus aurantiifolia</i>	Rutaceae	Lime	C2,D2
18277	<i>Cocos nucifera</i>	Areacaceae	Yellow Dwarf Variety	C3
18288	<i>Cocos nucifera</i>	Areacaceae	Large Green Variety	C3

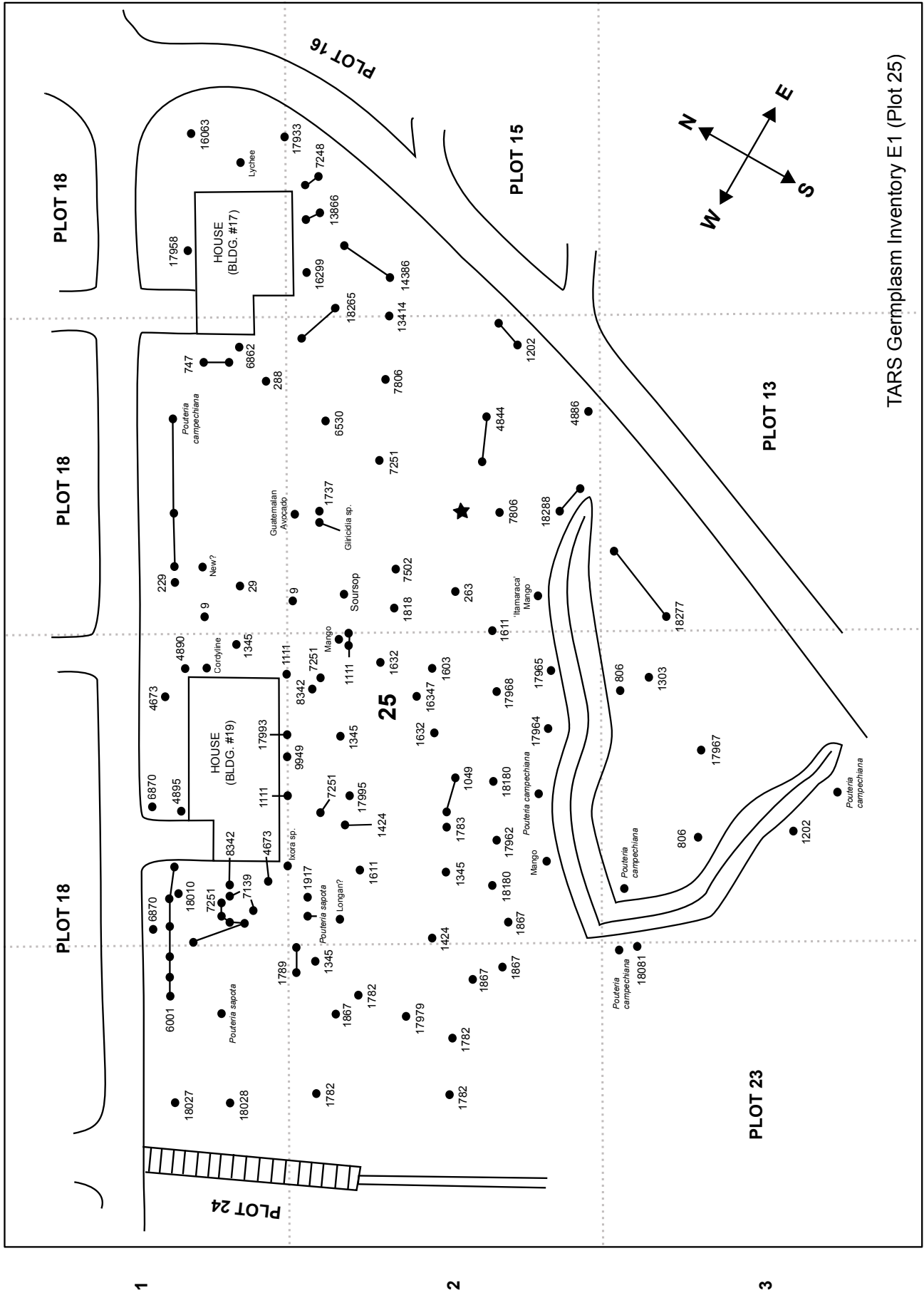

TARS Germplasm Inventory E1 (Plot 25)

★ GPS Coordinates: N 18°12.537 W 67°08.270

General Inventory - E1 (Plot 26)

TARS No.	Binomial	Family	Common Name	Location
225	<i>Elaeis guineensis</i>	Arecaceae	African Oil Palm	Several
288	<i>Swietenia macrophylla</i>	Melicaceae	Honduras Mahogany	A2
1303	<i>Lansium domesticum</i>	Meliaceae	Langsat	Several
1463	<i>Ilex cornuta</i>	Aquifoliaceae	Chinese Holly	D3
1750	<i>Phoenix reclinata</i>	Arecaceae	Senegal Date Palm	C1
1769	<i>Garcinia cochinchinensis</i>	Clusiaceae	False Mangosteen	A2
1833	<i>Sabal</i> sp.	Arecaceae	Inodes Palmetto	D1
1910	<i>Garcinia livingstonei</i>	Clusiaceae	African Mangosteen	A2, D3
1923	<i>Tectona grandis</i>	Lamiaceae	Teakwood	B2
2075	<i>Ficus virens</i>	Moraceae	Spotted Fig	B1, D2
2504	<i>Manilkara bidentata</i>	Sapotaceae	Bulletwood Tree	B1, D2
2523	<i>Cinnamomum camphora</i>	Lauraceae	Camphor Tree	C2
2534	<i>Ficus virens</i>	Moraceae	Spotted Fig	B2
2583	<i>Terminalia superba</i>	Combretaceae	Afara	B2
2676	<i>Licania rigida</i>	Chrysobalanaceae	Oiticica	B2
2914	<i>Areca macrocarpa</i>	Arecaceae	Betel Nut	D3
3623	<i>Fraxinus griffithii</i>	Oleaceae	Griffith's Ash	C2
3886	<i>Gardenia thunbergia</i>	Rubiaceae	White Gardenia	B2
3887	<i>Caesalpinia punctata</i>	Fabaceae	Bridal Veil	C1-2
4560	<i>Garcinia subelliptica</i>	Clusiaceae	Happiness Tree	A2
4592	<i>Bauhinia purpurea</i>	Fabaceae	Purple Orchid Tree	B1
4673	<i>Pimenta racemosa</i>	Myrtaceae	Bay Rum Tree	C2
4823	<i>Garcinia xanthochymus</i>	Clusiaceae	Sour Mangosteen	C2
4844	<i>Lecythis minor</i>	Lecythidaceae	Monkey Pot Nut	D1
4959	<i>Rosenbergiodendron formosum</i>	Rubiaceae	Blackberry Jam Fruit	D1
5665	<i>Parmentiera aculeata</i>	Bignoniaceae	Guajilote	B1
5724	<i>Hiptage benghalensis</i>	Malpighiaceae	Hiptage	C2
6005	<i>Flacourtia rukam</i>	Salicaceae	Governor's Plum	B1
6392	<i>Heliconia latispatha</i>	Heliconiaceae	-	D2, D3
6635	<i>Schnella glabra</i>	Fabaceae	Bejuco de Cadena	B2
6804	<i>Livistona robinsoniana</i>	Arecaceae	-	C3
6813	<i>Garcinia benthamii</i>	Clusiaceae	Bunac	A2
6815	<i>Garcinia cornea</i>	Clusiaceae	-	A2
7303	<i>Ormosia panamensis</i>	Fabaceae	Peronía	C2
11868	<i>Bauhinia monandra</i>	Fabaceae	Butterfly Flower	C2
16021	<i>Salacca zalacca</i>	Arecaceae	Salak	B2, C2
17942	<i>Heliconia caribaea</i>	Heliconiaceae	Macaw Flower	D2
18011	<i>Garcinia portoricensis</i>	Clusiaceae	Palo de Cruz (P.R.)	C2
18033	<i>Heliconia</i> sp.	Heliconiaceae	Sexy Pink	D2
18035	<i>Coccoloba pubescens</i>	Polygonaceae	Mountain Grape	D2
18036	<i>Spondias mombin</i>	Anacardiaceae	Jobo Gusanero	D2

General Inventory - E1 (Plot 26)

TARS No.	Binomial	Family	Common Name	Location
18039	<i>Metroxylon amicarum</i>	Arecaceae	Ivory Nut Palm	D3
18044	<i>Musa velutina</i>	Musaceae	Velvet Pink Banana	D3
18074	<i>Canarium pimela</i>	Burseraceae	Chinese Black Olive	C2
18087	<i>Coffea arabica</i>	Rubiaceae	Caturra	D3
18157	<i>Musa coccinea</i>	Musaceae	Scarlet Banana	D3
18159	<i>Musa acuminata</i>	Musaceae	Unknown Ornamental	D3
18164	<i>Saccharum officinarum</i>	Poaceae	Sugar Cane	C3
18167	<i>Pseudanmomis umbellulifera</i>	Myrtaceae	Monos Plum	C2

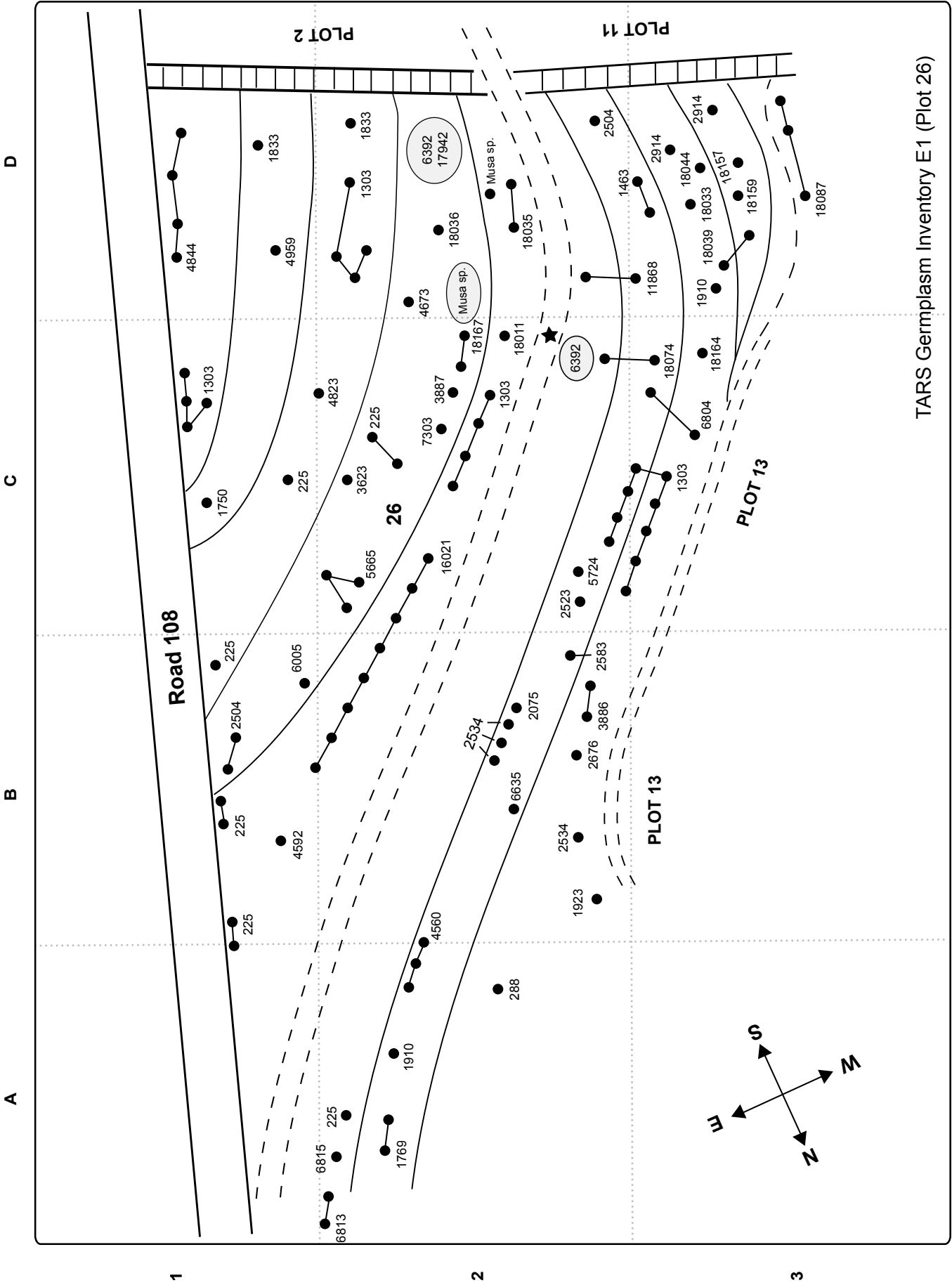

TARS Germplasm Inventory E1 (Plot 26)

★ GPS Coordinates: N 18°12.513 W 67°08.188

INDEX

A

- ACAI PALM see *Euterpe oleracea*
Acalypha chamaedrifolia 28
Acalypha hispida 32
Acalypha sp. 22
 ACEROLA see *Malpighia emarginata*
 ACHACHAIRU see *Garcinia humilis*
Adansonia digitata 30
Adenantha pavonina 1, 23
Adonia merrillii 1, 20, 25, 28
Aegle marmelos 15
 AFARA see *Terminalia superba*
 AFRICAN MANGOSTEEN see *Garcinia livingstonei*
 AFRICAN NUTMEG see *Monodora myristica*
 AFRICAN OIL PALM see *Elaeis guineensis*
 AFRICAN PEACH see *Nauclea orientalis*
 AFRICAN TULIP TREE see *Spathodea campanulata*
Agave americana 13, 25
Aleurites moluccanus 1
 ALEXANDRIAN LAUREL see *Calophyllum inophyllum*
Allamanda blanchetii 33
Allamanda cathartica
 'Double' 8
Allamanda nerifolia 28
Alocasia macrorrhizos 8
Alocasia x amazonica 8
 ALPHONSE KARR BAMBOO see *Bambusa multiplex*
Alpinia purpurata
 'Pink Ginger' 8
 'Red Ginger' 6, 28
 'Rosy Dawn' 7
 'Tahitian' 7
Alpinia zerumbet
 'Pink porcelain Lily' 6
 'Variegated Shell' 7, 25
Alstonia macrophylla 15
Alstonia scholaris 15
 ALUPAG see *Litchi chinensis* subsp. *Philippinensis*
Amorphophallus paeoniifolius 7, 10
 ANACAHUITA see *Sterculia apetala*
Anacardium occidentale 20
 ANGEL'S TRUMPET see *Brugmansia x candida*
 ANNATTO see *Bixa orellana*
Annona montana 23
Annona mucosa 15, 23
Annona muricata 20
Annona purpurea 32
Annona reticulata 23
Antidesma bunius 25, 28, 32
 ANT TREE see *Triplaris cumingiana*
 APPLEBLOSSOM SHOWER see *Cassia javanica*
Arachis glabrata 12, 28
Arachnis x maingayi 'Yellow Ribbon' 5
Araucaria heterophylla 1, 4
Ardisia solanacea 10, 17, 20
 ARBORVITAE see *Thuja* sp.
Areca macrocarpa 20, 35
Arenga pinnata 6
Arenga tremula 4
 ARROW BAMBOO see *Pseudosasa japonica*
 ARROWROOT see *Maranta arundinacea*
Artocarpus altilis
 'Breadfruit' 20, 28
 'Seeded Breadfruit' 12
 'Samoa' 7
Artocarpus heterophyllus 1, 6, 15, 23, 25
Artocarpus hypargyreus 8
Artocarpus lacucha 7
Artocarpus odoratissimus 7
Artocarpus sp. 7
Arundinaria hindsii 10
Arundinaria oleosa 12
Asclepias curassavica 12
 ASIAN BUSHBEECH see *Gmelina asiatica*
Attalea gomphococca 7
 AUREUM see *Epipremnum pinnatum*
Averrhoa bilimbi 23
Averrhoa carambola 7, 32
 'B-10' 7
 'Butt's Dwarf' 7
 'Fwang Tung' 7
 'Golden Star' 7
 'Hart' 7
 'Hew #1' 7
 'Key West' 7
 'Light Yellow Fruit' 10
 'Thai Knight' 7
 'Wheeler' 7
 AVOCADO see *Persea americana*
Azadirachta indica 25

B

- Bactris gasipaes* 12
 'gasipaes' 10
 BAEL FRUIT see *Aegle marmelos*
 BAI GUI MU see *Artocarpus hypargyreus*
 BAKER'S SHOWER TREE see *Cassia bakeriana*
 BAKONG see *Pandanus dubius*
 BAKUPARI see *Garcinia brasiliensis*
 BAMBOO see *Bambusa vulgaris*
Bambusa bambos 30
Bambusa blumeana 30
Bambusa dissimulator 30
Bambusa lako 30
Bambusa longispiculata 30
Bambusa multiplex
 'Alphonse Karr' 11, 20, 30
 'Silverstripe' 11
 'Riviereorum' 11
Bambusa oldhamii 30
Bambusa polymorpha 15, 30

- Bambusa* sp. 15
Bambusa textilis 12, 30
Bambusa tulda 30, 32
 'old form' 30
Bambusa tuldooides 30
Bambusa ventricosa 30
Bambusa vulgaris 10, 30
 'Vittata' 10, 30
 BAOBAB see *Adansonia digitata*
Barringtonia sp. 10
 BASTARD COPPERLEAF see
 Acalypha chamaedrifolia
 BATINO see *Alstonia*
 macrophylla
Bauhinia monandra 4, 35
Bauhinia purpurea 35
Bauhinia sp. 17, 25
 BAY RUM TREE see *Pimenta*
 racemosa
 BEEFSTEAK HELICONIA see
 Heliconia mariae
 BEJUCO DE CADENA see
 Schnella glabra
 BENGAL BAMBOO see
 Bambusa tulda
 BENJAMIN'S FIG see *Ficus*
 benjamina
 BERRY BAMBOO see
 Melocana baccifera
 BETEL NUT see *Areca*
 macrocarpa
 BIGNAY see *Antidesma bunius*
 BILIMBI see *Averrhoa bilimbi*
 BINUCAO see *Garcinia binucao*
 Bischofia javanica 7
 BISMARCK PALM see
 Bismarckia nobilis
 Bismarckia nobilis 22
 Bixa orellana 12
 BLACK BAMBOO see
 Phyllostachys nigra
 BLACK PEPPER see *Piper*
 nigrum
 BLACK SAPOTE see *Diospyros*
 digyna
 BLACKBERRY JAM FRUIT see
 Randia formosa
 BLUE MAHOE see *Hibiscus*
 elatus
 BLUE JACARANDA see
 Jacaranda mimosifolia
Bombax ceiba 25
Borassus flabellifer 4
 BOROJO see *Borojoa patinoi*
Borojoa patinoi 15
 BORY see *Phyllostachys nigra*
 'Bory'
 BOTTLEBRUSH TREE see
 Callistemon citrinus
Bougainvillea sp. 24
Brachystachyum densiflorum 12
 BRAZILIAN ROSE (DOUBLE)
 see *Cochlospermum*
 vitifolium
 BREADFRUIT see *Artocarpus*
 altilis
 BRIDAL BOUQUET see
 Plumeria pudica
 BRIDAL VEIL see *Caesalpinia*
 punctata
 BRONZE BANANA see *Musa*
 laterita
Brosimum alicastrum 23
Brownea grandiceps 4, 15
Brownea macrophylla 15
Brugmansia sp. 12
 'Angel's Trumpet' (Pink) 8
 'Angel's Trumpet' (White) 12
Brugmansia x candida
 'Angel's Trumpet' 7, 8
 BUDDHA'S BELLY BAMBOO
 see *Bambusa ventricosa*
 BULLETWOOD TREE see
 Manilkara bidentata
 BUNAC see *Garcinia benthamii*
 BUSH ALLAMANDA see
 Allamanda neriifolia
 BUSH RUBBER see *Funtumia*
 elastica
 BUTTERFLY FLOWER see
 Bauhinia monandra
Byrsonima crassifolia 10

 C

Caesalpinia punctata 35
 CALABAO see *Uvaria rufa*
 CALABASH TREE see
 Crescentia cujete
Calamus viminalis 4
Calathea allouia 8
 CALCUTTA BAMBOO see
 Dendrocalamus strictus
Calliandra haematocephala 17
Calliandra surinamensis 20
Callistemon citrinus 4, 32
Calophyllum inophyllum 30
Calophyllum sp. 'Variegated' 18
Calycophyllum candidissimum 15
 CAMPHOR TREE see
 Cinnamomum camphora
Cananga odorata 17, 20, 32
Canarium pimela 36
 CANDLE TREE see *Parmentiera*
 cereifera
 CANDLEBERRY TREE see
 Aleurites moluccanus
 CANISTEL see *Pouteria*
 campechiana
Canna indica 12
 CANNONBALL TREE see
 Couroupita guianensis
 CAPE LEADWORT see
 Plumbago auriculata
 CARANDAS PLUM see *Carissa*
 spinarum
 CARDINAL'S GUARD see
 Pachystachys coccinea
 CARIBBEAN PINE see *Pinus*
 caribaea
Carissa spinarum 15
Carludovica palmata 4, 6
 CARNIVAL BUSH see *Ochna*
 mossambicensis
Caryota sp. 4, 32
Caryota urens 4, 25, 32
 CAS see *Psidium*
 friedrichsthalianum
 CASHEW see *Anacardium*
 occidentale
Cassia bakeriana 15
Cassia javanica 25
Cassia x nealiae 30
Catalpa longissima 17
 CATOLE PALM see *Syagrus*
 oleracea
 CAT'S CLAW see *Macfadyena*
 unguis-cati
 CATURRA see *Coffea arabica*

- Cavanillesia platanifolia* 1, 15, 17, 32
Cecropia peltata 4, 25
 CEIBA see *Ceiba pentandra*
Ceiba pentandra 23, 25
 CENTURY PLANT see *Agave americana*
Cephalostachyum pergracile 30
 CEREIPO see *Myrospermum frutescens*
 CERIMAN see *Monstera deliciosa*
 CEYLON GOOSEBERRY see *Dovyalis hebecarpa*
 CHALICE VINE see *Solandra grandiflora*
 CHAN CHUK see *Phyllostachys nidularia* 'Smoothsheat'
 CHAYA see *Cnidioscolus aconitifolius*
Cheilocostus speciosus 6, 10
 CHERRY MANGOSTEEN see *Garcinia intermedia*
 CHINESE BLACK OLIVE see *Canarium pimela*
 CHINESE BOX ORANGE see *Severina buxifolia*
 CHINESE CINNAMON see *Cinnamomum aromaticum*
 CHINESE HAT FLOWER see *Holmskioldia sanguinea*
 CHINESE HAT (RED) see *Holmskioldia sanguinea*
 CHINESE HOLLY see *Ilex cornuta*
 CHOCH see *Pouteria glomerata* subsp. *glomerata*
Chrysobalanus icaco 33
 'Rosado' 15
Chrysophyllum cainito 7, 23
Chrysophyllum oliviforme 7
 CHUNG CHUK see *Phyllostachys purpurata*
 'Straightstem'
 CINNAMON TREE see *Cinnamomum verum*
Cinnamomum aromaticum 6
Cinnamomum camphora 23, 35
Cinnamomum verum 6
- CITRON-CENT GUM see *Corymbia citriodora*
Citrus aurantiifolia 18, 20, 33
Citrus limonia 23
Citrus maxima
 'Father Jerome' 17
 'Flat Dry Pink' 17
 'Kao Pane' 2
 'Ogami' 1
 'Thong Dee' (White) 17
Clerodendrum quadriloculare 12
Clerodendrum thomsoniae 13
Clusia major 15
Cnidioscolus aconitifolius 8
 COAST HIBISCUS see *Hibiscus tiliaceus*
Coccoloba pubescens 35
Cochlospermum vitifolium
 'Double' 33
Cocos nucifera 1, 17
 'Yellow Dwarf' 18, 20, 21, 28, 26, 33
 COCONUT PALM see *Cocos nucifera*
Codiaeum variegatum 1, 6, 10, 17, 20, 25, 28, 32
 COFFEE see *Coffea arabica*
Coffea arabica 7, 36
Coix lacryma-jobi 12
Cola acuminata 15, 17
Colubrina elliptica 23
Combretum indicum 1, 23
Combretum sp. 25
 COMMON BAMBOO see *Bambusa vulgaris*
 COMMON GINGER see *Zingiber officinale*
 COMMON HIBISCUS see *Hibiscus rosa-sinensis*
Congea tomentosa 4
 CORAL HIBISCUS see *Hibiscus schizopetalus*
 CORAL PLANT see *Russelia equisetiformis*
Cordyline fruticosa
 'Concha Capifali' 6
Cordyline sp. 3
Corymbia citriodora 15
Corypha umbraculifera 4, 6, 23
Costus spicatus 6
- Coroupita guianensis* 1
 CRABOO see *Byrsonima crassifolia*
 CREPE GINGER see *Cheilocostus speciosus*
 CREPE JASMINE see *Tabernaemontana divaricata*
Crescentia cujete 15, 32
Crossandra infundibuliformis 7
 CROTON see *Codiaeum variegatum*
Cryptostegia grandiflora 28
Cyperus alternifolius 6
 CUBAN ROYAL PALM see *Roystonea regia*
 CUPEY see *Clusia major*
 CUPUAÇU see *Theobroma grandiflorum*
 CURCUMA see *Curcuma* sp.
Curcuma longa 8
Curcuma sp. 8
 CUSTARD APPLE see *Annona reticulata*
Cymbopogon citratus 8
Cyperus involucratus 6
- D
- DAGAME see *Calycophyllum candidissimum*
 DAVID BISSET'S BAMBOO see *Phyllostachys bissetii*
Delonix regia 1, 15, 25
Dendrocalamus asper 30
Dendrocalamus strictus 30
 DEVIL TREE see *Alstonia scholaris*
 DILLENIA see *Dillenia indica*
Dillenia indica 6
Dimocarpus longan 32
Dioon edule 6
Dioon spinulosum 6
Diospyros blancoi 28
Diospyros digyna 1, 15
Dolichandra unguis-cati 15
Dombeya tiliacea 25
 DONKA see *Sandoricum koetjape*
Dovyalis caffra 32
Dovyalis hebecarpa 28

x abyssinica 32
 DRACAENA FIG see *Ficus pseudopalma*
Dracaena fragrans 6, 20, 32
Dracaena marginata 28
 DROOPING TIMBER BAMBOO see *Phyllostachys flexuosa*
 DURIAN see *Durio zibethinus*
Durio zibethinus 28, 32
 DUTCHMAN'S-PIPE CACTUS see *Epiphyllum oxypetalum*
 DWARF DATE PALM see *Phoenix roebelenii*
 DWARF FERNLEAF BAMBOO see *Pleioblastus distichus*
 DWARF GRENSTRIPE BAMBOO see *Pleioblastus viridistriata*
Dypsis lutescens 1, 20, 28, 32
Dypsis madagascariensis 4

E

Elaeis guineensis 20, 25, 28, 35
 ELEGANT BAMBOO see *Phyllostachys elegans*
 ELEPHANT EAR see *Enterolobium cyclocarpum*
 ELEPHANT YAM see *Amorphophallus paeoniifolius*
Enterolobium cyclocarpum 1, 4, 8
Epiphyllum oxypetalum 12
Epipremnum pinnatum 4, 28
Eriobotrya deflexa 17
Erythrina fusca 25
Erythrina variegata 17
Euterpe olereacea 2
Etlingera elatior
 'Red Torch Ginger' 10
 'Pink Torch Ginger' 6
Eucalyptus sp. 17
Eugenia lineata 32
Eugenia uniflora 20
Euterpe oleracea 2

F

FA CHUA, TING CHAA CHOW see *Phyllostachys glauca*

FALSE LOCUST see *Hebestigma cubense*
 FALSE MANGOSTEEN see *Garcinia cochinchinensis*
 FALSE RUBBERWOOD see *Mascarenhasia arborescens*
 FALSE SICKLEPOD see *Senna multijuga*
 FALSE TUNG OIL TREE see *Garcia nutans*
Ficus benjamina 25, 28
Ficus elastica
 'Decora' 1
Ficus nota 10
Ficus pseudopalma 12
Ficus religiosa 17
Ficus virens 35
 FIRECRACKER FLOWER see *Crossandra infundibuliformis*
 FISHTAIL PALM see *Caryota urens*
Flacourtia rukam 17, 23, 35
Flacourtia sp. 1
 FLAMBOYANT TREE see *Delonix regia*
 FLAME VINE see *Pyrostegia venusta*
 FLAMEGOLD see *Koelreuteria elegans*
 FLOODED GUM see *Eucalyptus* sp.
 FLOWERING BANANA see *Musa ornata*
 FLOWERING PANDANUS see *Freycinetia multiflora*
 FOO (WONG) CHUK see *Phyllostachys mannii*
Franixus griffithii 35
 FRENCH OAK see *Catalpa longissima*
Freycinetia multiflora 25
 FRIED EGG TREE see *Oncoba spinosa*
Funtumia elastica 30
 FURRY JASMINE see *Jasminum multiflorum*

G

Garcia nutans 4

Garcinia benthamii 15, 35
Garcinia binucao 4, 28
Garcinia brasiliensis 13
Garcinia cochinchinensis 35
Garcinia cornea 35
Garcinia cymosa 7
Garcinia hombroniana 13
Garcinia humilis 26, 33
Garcinia intermedia 23
Garcinia livingstonei 35
Garcinia madruno 12
Garcinia magnifolia 13
Garcinia mangostana 10, 20, 32
Garcinia portoricensis 35
Garcinia subelliptica 35
Garcinia venulosa 32
Garcinia xanthochymus 35
Gardenia thunbergia 35
 Garlic Vine see *Mansoa alliacea*
Genipa americana 18
 GERANIUM ARALIA see *Polyscias guilfoylei*
 GIANT BAMBOO see *Dendrocalamus asper*
 GIANT FISHTAIL PALM see *Caryota urens*
 GIANT PASSIONFRUIT see *Passiflora quadrangularis*
 GIANT RAMBUTAN see *Nephelium cuspidatum* var. *Robustum*
 GIANT THORNY BAMBOO see *Bambusa bambos*
 GIANT TIMBER BAMBOO see *Phyllostachys bambusoides*
 Same common name for both.
 GINGER see *Zingiber officinale*
Gigantochloa apus 30
Gmelina asiatica 10
Gmelina philippensis 28
Goetzea elegans 26
 GOLDEN BAMBOO see *Phyllostachys aurea*
 GOLDEN PALM see *Dypsis lutescens*
 GOLDEN TORCH see *Heliconia* sp.
 GOMA see *Funtumia elastica*
 GOOSEBERRY see *Phyllanthus acidus*

GOVERNOR'S PLUM see
Flacourtia rukam
 GRAND NAIN see *Musa*
acuminata
 GREEN SULPHUR BAMBOO
 see *Phyllostachys sulphurea*
 var. *viridis*
 GRIFFITH'S ASH see *Fraxinus*
griffithii
Guadua angustifolia 30
 GUAJILOTE see *Parmentiera*
aculeata
 GUAMA see *Inga spectabilis*
 GUANABANA see *Annona*
muricata
 GUAYABO FAISÁN see
Ruprechtia coriacea
 GUAYABO VOLADOR see
Ruprechtia ramiflora
 GUIANA CHESTNUT see
Pachira aquatica
 GUEST TREE see *Kleinhovia*
hospita
 GUINEA ARROWROOT see
Calathea allouia
 GUYANA see *Heliconia* sp.

H

HALF-BLACK BAMBOO see
Phyllostachys arcane
 HAPPINESS TREE see *Garcinia*
subelliptica
Handroanthus chrysanthus 1, 17,
 23
Haplophragma adenophyllum 17
 HARD ALSTONIA see *Alstonia*
macrophylla
Hebestigma cubense 32
 HEDGE BAMBOO see *Bambusa*
multiplax
Hedychium coronarium 8
Hedychium flavum 8, 20
Heliconia bihai 12
Heliconia caribaea 7, 35
Heliconia latispatha 6, 35
Heliconia mariae 7
Heliconia platystachys 8, 12
Heliconia psittacorum 12, 20
Heliconia sp.

'Golden Torch' 33
 'Guyana' 12
 'Sexy Pink' 35
 'Tortuga Hybrid' 7
 HENON see *Phyllostachys nigra*
Herrania pulcherima 8
Herrania purpurea 8
Herrania sp. 8
Herrania sp. #1 8
Herrania sp. #2 8
Herrania umbratica 8
Hevea brasiliensis 28, 32
 HIBISCUS see *Hibiscus rosa-*
sinensis
Hibiscus elatus 17
Hibiscus rosa-sinensis 1, 20, 25
Hibiscus schizopetalus 7
Hibiscus tiliaceus 13
 HIPTAGE see *Hiptage*
benghalensis
Hiptage benghalensis 35
 HOGPLUM see *Spondias*
mombin
Holmskioldia sanguinea 1,
 'Red' 2
Holoptelea integrifolia 10, 17
 HONDURAS MAHOGANY see
Swietenia macrophylla
Hylocereus trigonus 15
Hyophorbe verschaffeltii 4, 6

I

ICACO see *Chrysobalanus icaco*
 ILANG-ILANG see *Cananga*
odorata
Ilex cornuta 35
 IMPERIAL BROMELIAD see
Vriesea imperialis
 INDIA RUBBER FIG see *Ficus*
elastica
 INDIAN CORAL TREE see
Erythrina variegata
 INDIAN ELM see *Holoptelea*
integrifolia
 INDIAN JUJUBE see *Ziziphus*
mauritiana
 INDIAN KAPOK see *Bombax*
ceiba
Indocalamus solidus 12

Inga spectabilis 33
 INODES PALMETTO see
Sabal sp.
 IVORY NUT PALM see
Metroxylon amicarum
 IVY-ARUM see *Epipremnum*
pinnatum
Ixora acuminata 1
Ixora coccinea 1, 10
Ixora sp. 12, 20, 28

J

JACARANDA see *Jacaranda* sp.
Jacaranda mimosifolia 2
Jacaranda sp. 2, 25
 JACKFRUIT see *Artocarpus*
heterophyllus
 JAGUA see *Genipa americana*
 JAGUEILLO see *Vitex divaricata*
 JAMBOLAN see *Syzigium cumini*
 JAPANESE BISHOPWOOD see
Bischofia javanica
 JAPANESE JEW see
Podocarpus macrophyllus
Jasminum multiflorum 1
Jatropha curcas 15
 JAVA OLIVE see *Sterculia*
foetida
 JERUSALEM LEMON see
Triphasia trifolia
 JOBO GUSANERO see
Spondias mombin

K

KA FAT TO CHUK see
Phyllostachys
rubromarginata
 KAM SZ CHUK see
Phyllostachys nidularia
 KAN CHUK see *Phyllostachys*
nidularia
 KAPOK see *Ceiba pentandra*
 KARENWOOD see
Haplophragma adenophyllum
 KEI APPLE see *Dovyalis caffra*
Kigelia africana 1, 20
Kleinhovia hospita 1
Koelreuteria elegans 30

KOLA NUT see *Cola acuminata*
KOON YAM CHUK see
Bambusa multiplex
'Riviereorum'
Kopsia fruticosa 33
KWAI CHUK see *Phyllostachys*
sulphurea var. *viridis*
KYATHAUNG-WA see *Bambusa*
polymorpha

L

LADY ELEGANT PALM see
Rhapis excelsa
Lagerstroemia sp. 17
Lagerstroemia speciosa 1, 10,
17, 32
LAI TSAI CHUK see
Phyllostachys purpurata
'Tipical'
LAK CHA CHUK see
Phyllostachys nidularia
LAKOOCHA see *Artocarpus*
lacucha
LANGSAT see *Lansium*
domesticum
Lansium domesticum 6, 28, 32,
35
LARGE GREEN VARIETY see
Cocos nucifera
Lecythis minor 32, 35
Leea guineensis 17, 20
'Violacea' 18
LEMON GRASS see
Cymbopogon citratus
Licania platypus 15
Licania rigida 35
LICURY PALM see *Syagrus*
coronata
LIME see *Citrus aurantiifolia*
Litchi chinensis 10, 23, 30, 32
Litchi chinensis subsp.
philippinensis 4, 6
Livistona robinsoniana 35
Livistona sp. 10
LONGAN see *Dimocarpus*
longan
LONGBOY see *Syzygium cumini*
LONGHORN ANT TREE see
Triplaris americana

LUCUBA PALM see *Dypsis*
madagascariensis
LYCHEE see *Litchi chinensis*

M

MABOLO see *Diospyros blancoi*
MACADAMIA NUT see
Macadamia integrifolia
Macadamia integrifolia 32
MACARTHUR'S PALM see
Ptychosperma macarthurii
MACAW FLOWER see *Heliconia*
caribaea
Macfadyena unguis-cati 15
MADROÑO see *Garcinia*
madruno
MADROÑO LISO see *Garcinia*
magnifolia
MAGA see *Thespesia grandiflora*
MAGNOLIA see *Magnolia* sp.
Magnolia sp. 20
MAHOGANY see *Swietenia*
mahagoni
MAKINO BAMBOO see
Phyllostachys makinoi
MALAGUETA see *Pimenta*
racemosa
MALAY APPLE see *Syzygium*
malaccense
Malpighia coccigera 28
Malpighia emarginata 18, 23, 32
MAMEY see *Mammea*
americana
MAMEY SAPOTE see *Pouteria*
sapota
Mammea americana 6
Mangifera indica 17
'Amini' 30
'Cambodiana' 28
'Edward' 28
'Davis Haden' 33
'Irwin' 28
'Keit' 28, 33
'Kent' 33
'Lippens' 33
'Palmer' 28
'Springfield' 33
'Sufaida' 18
'Tommy Atkins' 28

MANGO see *Mangifera indica*
MANGOSTEEN see *Garcinia*
mangostana
MAPUEY see *Canna indica*
MALABAR BAUHINIA see
Ptilostigma malabaricum
MALTESE CROSS see *Ixora*
coccinea
MANILA PALM see *Adonidia*
merrillii
MANILA TAMARIND see
Pithecelobium dulce
Manilkara bidentata 35
Manilkara zapota 23
Mansoa alliacea 13
MARANG see *Artocarpus*
odoratissimus
Maranta arundinacea 8
MARTINIQUE GINGER *Zingiber*
zerumbet
MARTINIQUE TRIMEZIA see
Trimezia martinicensis
Mascarenhasia arborescens 30,
32
MATABUEY see *Goetzea*
elegans
MUI TIM CHUK see
Phyllostachys bambusoides
MAVI see *Colubrina elliptica*
MAYAN BREADNUT see
Brosimum alicastrum
Melicoccus bijugatus 1
Melocanna baccifera 30
Metroxylon amicarum 36
MEXICAN BREAD FRUIT see
Monstera deliciosa
MEXICAN VANILLA see *Vanilla*
planifolia
MEYER BAMBOO see
Phyllostachys meyeri
MILKWEED see *Asclepias*
curassavica
Millettia pinnata 20
MINIATURE BAMBOO see
Pogonatherum paniceum
MIRACLE FRUIT see
Synsepalum dulcificum
MISS AGNES JOAQUIN see
Vanda hybrid

MONDO GRASS see
Ophiopogon japonicus
 MONKEY POT NUT see *Lecythis minor*
Monodora myristica 7
 MONOS PLUM see
Pseudanmomis umbellulifera
Monstera deliciosa 6, 25
Montezuma speciosissima see
Thespesia grandiflora
Morus alba 10
Morus sp. 10
 MOUNTAIN CABAGE PALM see
Prestoea acuminata
 MOUNTAIN COCOA see
Theobroma angustifolium
 MOUNTAIN GRAPE see
Coccoloba pubescens
 MUDDY BAMBOO see *Bambusa dissimulator*
 MUELLER'S TERMINALIA see
Terminalia muelleri
 MU'K CHUK see *Phyllostachys purpurata* 'Solidstem'
 MULBERRY see *Morus alba*
Murraya paniculata 20, 23, 32
Musa acuminata
 'Grand Nain' 7
 'Kirkinan' 7
 'Siam Ruby 12'
 'Unknown Ornamental' 36
Musa coccinea 8, 36
Musa hybrid 8
Musa laterita 8
Musa ornata 7
Musa velutina 8, 36
Mussaenda erythrophylla 28
Mussaenda frondosa 20
Myristica fragrans 6
Myrospermum frutescens 4

N

N-05-6 see *Psidium guajava*
 NARIHIRA BAMBOO see
Semiarundinaria fastuosa
Nauclea orientalis 15
 NEEDLE-FLOWER TREE see
Posoqueria latifolia

NEEM see *Azadirachta indica*
 NEGROHEAD see *Annona purpurea*
Nephelium cuspidatum var.
 Robustum 33
Nephelium lappaceum 7
Nephelium ramboutan-ake 15, 33
 NEPHTYTHIS see *Syngonium podophyllum*
 NIGHT BLOOMING CEREUS
 see *Hylocereus trigonus*
 NISPERO JAPONES see
Eriobotrya deflexa
 NORFOLK ISLAND PINE see
Araucaria heterophylla
 NUDE SHEATH BAMBOO see
Phyllostachys nuda
 NUTMEG AND MACE see
Myristica fragrans

O

Ochna mossambicensis 25
 OCTOPUS TREE see *Schefflera actinophylla*
Odontonema tubaeforme 7
 OITICICA see *Licania rigida*
 OKARI NUT see *Terminalia kaernbachii*
 OLDHAM'S BAMBOO see
Bambusa oldhamii
Oncoba spinosa 12
 ORANGE DWARF see *Ixora* sp.
 ORANGE IXORA see *Ixora coccinea*
 ORANGE JESSAMINE see
Murraya paniculata
 ORANGE VARIETY see
Heliconia bihai
 ORCHID TREE see *Bauhinia* sp.
Ormosia panamensis 35
 ORNAMENTAL PEANUT see
Arachis glabrata
Ophiopogon japonicus 6

P

Pachira aquatica 6, 15
Pachystachys coccinea 2

PADOUK see *Pterocarpus indicus*
 PALMYRA PALM see *Borassus flabellifer*
 PALO DE CRUZ see *Garcinia portoricensis*
 PANAMA CANOE TREE see
Cavanillesia platanifolia
 PANAMA HAT PALM see
Carludovica palmata
Pandanus baptistii 25
Pandanus copelandii 17, 25
Pandanus dubius 4, 17, 28
Pandanus sp. 17, 26
Pandanus tectorius 25
 PARADISE TREE see
Simarouba glauca
 PARA RUBBER see *Hevea brasiliensis*
Parkia biglandulosa 1
Parkia sp. 1, 32
Parmentiera aculeata 1, 23, 35
Parmentiera cereifera 6
 PARROT'S BEAK see *Gmelina philippensis*
 PARROT'S FLOWER see
Heliconia psittacorum
Passiflora edulis 8
Passiflora quadrangularis 8
 PAU NUTS see *Barringtonia* sp.
 PEACH PALM see *Bactris gasipaes*
 PEDRO #1 see *Annona muricata*
 PEDRO #2 see *Annona muricata*
Peltophorum pterocarpum 12
 PERLA see *Psidium guajava*
 PERONÍA see *Ormosia panamensis*
Persea americana 1, 32, 34
Petrea volubilis 6
 PHILIPPINE SUGAR PALM see
Arenga tremula
Philodendron bipinnatifidum 7, 17, 20
Philodendron domesticum x
wendlandii 10
Phoenix reclinata 35
Phoenix roebelenii 18
Phoenix sylvestris 4
Phyllanthus acidus 15

- Phyllanthus acidus* 15
Phyllostachys angusta 11
Phyllostachys arcana 10
Phyllostachys aurea
 'Belgium' 11
Phyllostachys aureosulcata 10
 'Harbin' 12
 'S- 2765' 11
Phyllostachys bambusoides
 10, 11, 12, 30
 'All Gold' 12
Phyllostachys bissetii 11
Phyllostachys dulcis 10
Phyllostachys elegans 11
Phyllostachys flexuosa 11
Phyllostachys glauca 11
Phyllostachys makinoi 11
Phyllostachys mannii 10
Phyllostachys meyeri 11
Phyllostachys nidularia
 'Smoothsheath' 11
Phyllostachys nigra 10, 11
 'Bory' 11
 'Hale' 10
 'Henon' 11
Phyllostachys nuda 11
Phyllostachys purpurata
 'Solidstem' 10, 11
 'Straightstem' 11
 'Typical' 11
Phyllostachys rubromarginata 11
Phyllostachys sulphurea var.
 viridis 11, 12
PIGMY BAMBOO see
 Pleioblastus fortunei
Piliostigma malabaricum 32
Pimenta racemosa 1, 6, 32, 35
PINK see *Ixora* sp.
PINK BLEEDING HEART see
 Clerodendrum thomsoniae
PINK IXORA see *Ixora* sp.
PINK PORCELAIN LILY see
 Alpinia zerumbet
PINK TORCH GINGER see
 Etilingera elatior
PINK VELVET BANANA see
 Musa velutina
Pinus caribaea 17
Piper nigrum 7
 'Balancota' 12
Pithecelobium dulce 6, 23
Pleioblastus chino 12
Pleioblastus distichus 12
Pleioblastus fortunei 12
Pleioblastus simonii 12
Pleioblastus viridistriata 12
Plumbago auriculata 7, 12
Plumeria pudica 8, 15
Plumeris sp. 22
Podocarpus macrophyllus 25
Pogonatherum paniceum 8
Polyalthia suberosa 4
Polygala cowellii 1, 6, 25
POLYMORPH BAMBOO see
 Bambusa polymorpha
Polyscias guilfoylei 10, 32
POMELO see *Citrus maxima*
POMPONA VANILLA see *Vanilla*
 pompona
PONGAM see *Millettia pinnata*
POON CHUK see *Phyllostachys*
 purpurata
Posoqueria latifolia 6, 15 17
Pouteria campechiana 27, 32, 34
Pouteria glomerata subsp.
 glomerata 15
Pouteria sapota 34
POWDER-PUFF see *Calliandra*
 haematocephala
Prestoea acuminata 4
PRIMAVERA see *Curcuma longa*
Pseudanmomis umbellulifera 36
Pseudobombax ellipticum 18
Pseudosasa cantorii
 'TRS-2501' 11
Pseudosasa japonica 11
Psidium cattleianum var.
 cattleianum 23
Psidium friedrichsthalianum 20
Psidium guajava 20
Psidium microphyllum 4
Pterocarpus indicus 10, 17, 25
Ptychosperma macarthurii 4, 17,
 28
Ptychosperma sp. 10
PUERTO RICAN GUAVA see
 Psidium microphyllum
PUERTO RICAN ROYAL PALM
 see *Roystonea borinquena*
PUERTO RICAN VIOLET TREE
 see *Polygala cowellii*
PULASAN see *Nephelium*
 ramboutan-ake
PUNTINGPOLE BAMBOO see
 Bambusa tuldooides
PURPLE ALAMANDA see
 Allamanda blanchetii
PURPLE CORAL TREE see
 Erythrina fusca
PURPLE ORCHID TREE see
 Bauhinia purpurea
PURPLE PASSIONFRUIT see
 Passiflora edulis
PURPLE WREATH see *Petrea*
 volubilis
Pyrostegia venusta 6, 28

Q
QU GAN ZHU see *Phyllostachys*
 flexuosa
QUEEN CRAPE MYRTLE see
 Lagerstroemia speciosa
QUEEN PALM see *Syagrus*
 romanzoffiana
QUENEPAPA see *Melicoccus*
 bijugatus
Quisqualis indica 1, 23

R
RAGOON CREEPER see
 Quisqualis indica
RAINBOW SHOWER TREE see
 Cassia x nealae
RAM-ROD BAMBOO see
 Arundinaria hindsii
RAMBUTAN see *Nephelium*
 lappaceum
Randia formosa 35
Ravenala madagascariensis 1,
 17, 20
RATTAN see *Calamus viminalis*
RED EDGE DRACAENA see
 Dracaena marginata
RED GINGER see *Alpinia*
 purpurata
RED HOT CAT'S TAIL see
 Acalypha hispida

- RED IXORA see *Ixora* sp.
RED MARGIN BAMBOO see
Phyllostachys
rubromarginata
RED MUSSAENDA see
Mussaenda erythrophylla
RED SANDALWOOD TREE see
Adenanthera pavonina
RED SANTOL see *Sandoricum*
koetjape
RED TORCH GINGER see
Etilingera elatior
Rhapis excelsa 28
Rheedia madruno see *Garcinia*
madruno
Rheedia portoricensis see
Garcinia portoricensis
RINGWORM TREE see *Senna*
alata
ROBERT YOUNG BAMBOO see
Phyllostachys sulphurea var.
viridis
ROBLE AMARILLO see
Handroanthus chrysanthus
Rollinia mucosa 15, 23
ROSE OF VENEZUELA see
Brownea grandiceps
Rosenbergiodendron formosum
35
Roseodendron donnell-smithii 1
ROUND LEAF CACAO see
Theobroma cacao
ROYAL POINCIANA see *Delonix*
regia
Roystonea borinquena 1, 4, 6,
15, 17, 20, 28, 32
Roystonea regia 28
RUBBER VINE see *Cryptostegia*
grandiflora
RUKAM see *Flacourtia rukam*
Ruprechtia coriacea 17
Ruprechtia ramiflora 10
RUSCUS-LEAF BAMBOO see
Shibataea kumasaca
Russelia equisetiformis 12
- S
- Sabal* sp. 35
Saccharum officinarum 36
- SACRED FIG see *Ficus religiosa*
SAH TSOH see *Phyllostachys*
angusta
Salacca zalacca 35
SALAK see *Salacca zalacca*
SALAMANDER TREE see
Antidesma bunius
SAMAN see *Samanea saman*
Samanea saman 1
SAN LORENZO see
Theobroma sp.
Sandoricum koetjape 15, 25
SANSAPOTE see *Licania*
platypus
SANTOL see *Sandoricum*
koetjape
Sapindus saponaria 1, 6
SAPODILLA see *Manilkara*
zapota
SATIN LEAF TREE see
Chrysophyllum oliviforme
SAUSAGE TREE see *Kigelia*
africana
SCARLET BANANA see *Musa*
coccinea
Schefflera actinophylla 17, 20, 25
Schnella glabra 35
SCREWPINE see *Pandanus*
copelandii
SEASHORE MANGOSTEEN see
Garcinia hombroniana
Semiarundinaria fastuosa 11
SENEGAL DATE PALM see
Phoenix reclinata
Senna alata 26
Senna multijuga 6
Severina buxifolia 1
SEXY ORANGE see *Heliconia*
platystachys
SEXY PINK see *Heliconia* sp.
SHARPLEAF IXORA see *Ixora*
acuminata
SHAT SAM CHUK, MAH CHUK
see *Phyllostachys purpurata*
‘Straightstem’
SHAVING BRUSH TREE see
Pseudobombax ellipticum
Shibataea kumasaca 12
SHOEBUTTON ARDISIA see
Ardisia solanacea
- SHOWER OF ORCHIDS see
Congea tomentosa
SHUI CHUK see *Phyllostachys*
purpurata ‘Solidstem’
SIAM RUBY see *Musa*
acuminata
SILK-TOP TATCH PALM see
Thrinax radiata
SILVER DATE PALM see
Phoenix sylvestris
SILVER STRIPE see *Bambusa*
multiplex ‘Silverstripe’
SILVER VARIETY see *Agave*
americana
Simarouba glauca 25
SIMON see *Pouteria*
campechiana
SIMON BAMBOO see
Pleioblastus simonii
SINGAPORE HOLLY see
Malpighia coccigera
Sinobambusa sp. 10, 12
‘TRS-2523’ 11
‘TRS-2524’ 11
‘TRS-2527’ 12
SLENDER CROOKSTEM see
Phyllostachys bambusoides
SOAPBERRY see *Sapindus*
saponaria
Solandra grandiflora 28
SOUR MANGOSTEEN see
Garcinia xanthochymus
SOURSOP see *Annona muricata*
SPANISH BAYONET see *Yucca*
aloifolia
Spathodea campanulata
‘Yellow Form’ 33
SPIKED SPIRAL FLAG see
Costus spicatus
SPINDLE PALM see *Hyophorbe*
verschaffeltii
SPINY BAMBOO see *Bambusa*
blumeana
Spondias mombin 20, 35
SPOTTED FIG see *Ficus virens*
STAR APPLE see
Chrysophyllum cainito
STARBURST see *Clerodendrum*
quadrioculare

STARFRUIT see *Averrhoa carambola*
Sterculia apetala 33
Sterculia foetida 7
 STRAWBERRY GUAVA see *Psidium cattleianum* var. *cattleianum*
 SUGAR CANE see *Saccharum officinarum*
 SUGAR PALM see *Arenga pinnata*
 SURINAM CHERRY see *Eugenia uniflora*
 SURINAM POWDER-PUFF see *Calliandra surinamensis*
 SWAMP ANAHAN see *Livistona* sp.
 SWEET TAMARIND SEEDLING see *Tamarindus indica*
 SWEETSHOOT BAMBOO see *Phyllostachys dulcis*
Swietenia macrophylla 1, 6, 17, 23, 25, 32, 35
Swietenia mahagoni 10, 15, 20, 23, 32
Swinglea glutinosa 15
Syagrus coronata 4
Syagrus oleracea 4
Syagrus romanzoffiana 4
Syngonium podophyllum 4, 6
Synsepalum dulcificum 1
Syzigium cumini 10
Syzigium malaccense 17

T

Tabebuia heterophylla 25
Tabebuia sp. 24
Tabernaemontana divaricata 10, 20, 25, 28, 32
 TABINDAING-WA see *Bambusa longispiculata*
 TABOG see *Swinglea glutinosa*
 TALIPOT PALM see *Corypha umbraculifera*
 TAMARIND see *Tamarindus indica*
Tamarindus indica 23
 TÁRTAGO see *Jatropha curcas*

TEAKWOOD see *Tectona grandis*
Tectona grandis 35
Terminalia catappa 17, 25, 33
Terminalia kaernbachii 25
Terminalia muelleri 1, 25
Terminalia superba 17, 35
Theobroma angustifolium 8
Theobroma bicolor 8
Theobroma cacao
 'Colorado' 7
 'Round Leaf Cacao' 8
 'White Cacao' 7
Theobroma gileri 8
Theobroma grandiflorum 8
Theobroma sp. 13
Thespesia grandiflora 2
 THONG DEE (WHITE) see *Citrus maxima*
 THOUSAND FINGERS see *Musa hybrid*
Thrinax radiata 17, 20
Thuja sp. 2
 TIGER COCOA see *Theobroma bicolor*
 TIMOR'S BLACK BAMBOO see *Bambusa lako*
 TINWA BAMBOO see *Cephalostachyum pergracile*
Tradescantia zebrina 26
 TRAVELER'S PALM see *Ravenala madagascariensis*
Trimezia martinicensis 28, 33
Triphasia trifolia 6, 15
Triplaris americana 25
Triplaris cumingiana 23, 25, 30, 32
 TROPICAL ALMOND see *Terminalia catappa*
 TRUMPET TREE see *Cecropia peltata*

U

UMBRELLA SEDGE see *Cyperus alternifolius*
 UMBRELLA TREE see *Schefflera actinophylla*
Uvaria ovata 15
Uvaria rufa 1, 10

V

VAGINATUS VARIEGATUS see *Pleioblastus chino*
Vanda hybrid 6
Vanilla planifolia 10, 12
Vanilla pompona 8, 12
 VARIEGATED HIBISCUS see *Hibiscus rosa-sinensis*
 VARIEGATED PANDANUS see *Pandanus baptistii*
 VARIAGATED SHELL see *Alpinia zerumbet*
 VARIEGATED SPORT see *Alocasia macrorrhizos*
 VARIEGATED VANILLA see *Vanilla planifolia*
 VELVET PINK BANANA see *Musa velutina*
 VENEZUELAN ROSE see *Brownea grandiceps*
 VIRRICK CLONE A see *Dovyalis hebecarpa x abyssinica*
Vitex divaricata 23
 VOLKAMER LEMON see *Citrus limonia*
Vriesea imperialis 26

W

WANDERING JEW see *Tradescantia zebrina*
 WATHO see *Gigantochloa apus*
 WEAVER'S BAMBOO see *Bambusa textilis*
 WEST INDIAN CHERRY see *Malpighia emarginata*
 WEST INDIAN MAHOGANY see *Swietenia mahagoni*
 WHITE CEDAR see *Tabebuia heterophylla*
 WHITE COCOA see *Theobroma cacao*
 WHITE GARDENIA see *Gardenia thunbergia*
 WHITE GINGER see *Hedychium coronarium*

WHITE MAHOGANY see

Roseodendron donnell-smithii

WILD SOURSOP see *Annona*

montana

WILD SWEETSOP see *Rollinia*

mucosa

WONGTUN CHUK see

Phyllostachys purpurata

'Straightstem'

X

Xanthosoma sp. 14

Y

YAGRUMO see *Cecropia peltata*

YELLOW-GROOVE BAMBOO

see *Phyllostachys*

aureosulcata

YELLOW POINCIANA see

Peltophorum pterocarpum

YELLOW POUI see

Handroanthus chrysanthus

Yucca aloifolia 17, 20, 25

Z

Zingiber officinale 8

Zingiber zerumbet 7

Ziziphus mauritiana 32



Field Guide to USDA-ARS TARS Plant Collections v. 1.0

2014 - USDA, ARS Tropical Agriculture Research Station
